



Catholic Educational Leadership Program

Student Handbook

2011-2012

University of San Francisco
School of Education
Institute for Catholic Educational Leadership

The following document, *Catholic Educational Leadership Student Handbook 2011-2012* is designed to provide students currently enrolled in the Catholic Educational Leadership (CEL) Program with an organized reference to the procedures and guidelines followed by the University of San Francisco, the School of Education, and the Catholic Educational Leadership Program. Every effort has been made to present information that is current (as of June 2011) and of greatest relevance and use to CEL students.

University policies and procedures pertaining to USF students, not explicitly addressed in this *Student Handbook*, can be found in the USF *Fogcutter* (<http://usfca.edu/fogcutter/>), the School of Education *USF Master of Arts & Credential Student Handbook 2011-2012*, and the School of Education *Doctoral Handbook 2011-2012*. SOE handbooks can be found at: http://usfca.edu/soe/students/handbooks_forms/

Policies, Guidelines, and Procedures published in this *Handbook*, governing enrollment and conduct of students in the Catholic Educational Leadership Program, take precedence over policies that may differ from those found in the USF *Fogcutter* or other School of Education student handbooks.

The University, the School of Education, and the Catholic Educational Leadership Program reserve the right to make changes in policies/procedures/curriculum. Such changes shall become effective, whenever the administration may determine. The policy of the University is to give advance notice of change(s) whenever possible to permit adjustment.

Table of Contents

Welcome.....	3
USF Vision, Mission, Values Statement.....	4
Statement of ICEL’s Mission.....	5
ICEL/CEL Goals and Outcomes.....	6
ICEL’s History.....	8
The CEL/ICEL Student.....	12
Office and CEL/ICEL Staff.....	14
Important Phone Numbers.....	15
Catholic Educational Leadership (CEL) Programs.....	16
Master of Arts in Catholic School Teaching.....	16
Master of Arts in Catholic School Teaching with a Concentration in Religious Education.....	17
Master of Arts in Catholic School Leadership.....	19
Culminating Project for Master.....	19
Certificate of Advanced Studies in Catholic Educational Leadership.....	24
California Preliminary Administrative Services Credential.....	25
California Clear Administrative Services Credential.....	25
California Teaching Credential/M.A.....	26
Doctor of Education in Catholic School Leadership.....	27
Doctoral Portfolio Review Process.....	28
Academic Guidelines and Requirements.....	29
Additional Academic Guidelines and Requirements for CEL Doctoral Students.....	35
Campus Services.....	38
Appendix A: Faculty Addresses and Telephone Numbers.....	41
Appendix B: CEL Doctoral Dissertation Titles.....	42
Appendix C: Campus Map.....	54

Welcome

The Institute for Catholic Educational Leadership (ICEL) welcomes you to the University of San Francisco. Student of the Catholic Educational Leadership Program (CEL) are important members of a scholarly community dedicated to the formation of Catholic school leaders, a network of committed individuals making a difference in Catholic education throughout the world.

CEL's academic programs have been designed to enrich the whole leader: academically, spiritually, and socially. Students and faculty study, pray, serve, and recreate together in a relaxing environment of scholarly pursuit on behalf of Catholic Education. We hope that this balance of lifestyle will make our students' stay at USF pleasant, as well as productive.

The CEL/ICEL Leadership Team has designed this handbook to familiarize students with the CEL program and the USF campus. Please do not hesitate to let us know how we can be of service.

We wish students every success in their studies at USF.

Sincerely,

Dr. Geoffrey R. Dillon, S.J.
Interim Director: ICEL

Janet Snyder
Administrative Assistant

Dr. Gini Shimabukuro
Faculty

Thanh Ly
Program Assistant

Dr. Doreen Jones
Faculty

VISION, MISSION *and* VALUES

of the University of San Francisco

Approved by the Board of Trustees September 11, 2001

VISION

The University of San Francisco will be internationally recognized as a premier Jesuit Catholic, urban University with a global perspective that educates leaders who will fashion a more humane and just world.

MISSION

The core mission of the University is to promote learning in the Jesuit Catholic tradition. The University offers undergraduate, graduate and professional students the knowledge and skills needed to succeed as persons and professionals, and the values and sensitivity necessary to be men and women for others.

The University will distinguish itself as a diverse, socially responsible learning community of high quality scholarship and academic rigor sustained by a faith that does justice. The University will draw from the cultural, intellectual and economic resources of the San Francisco Bay Area and its location on the Pacific Rim to enrich and strengthen its educational programs.

CORE VALUES

The University's core values include a belief in and a commitment to advancing:

- { 1 } the Jesuit Catholic tradition that views faith and reason as complementary resources in the search for truth and authentic human development, and that welcomes persons of all faiths or no religious beliefs as fully contributing partners to the University
- { 2 } the freedom and the responsibility to pursue truth and follow evidence to its conclusion
- { 3 } learning as a humanizing, social activity rather than a competitive exercise
- { 4 } a common good that transcends the interests of particular individuals or groups; and reasoned discourse rather than coercion as the norm for decision making
- { 5 } diversity of perspectives, experiences and traditions as essential components of a quality education in our global context
- { 6 } excellence as the standard for teaching, scholarship, creative expression and service to the University community
- { 7 } social responsibility in fulfilling the University's mission to create, communicate and apply knowledge to a world shared by all people and held in trust for future generations
- { 8 } the moral dimension of every significant human choice: taking seriously how and who we choose to be in the world
- { 9 } the full, integral development of each person and all persons, with the belief that no individual or group may rightfully prosper at the expense of others
- { 10 } a culture of service that respects and promotes the dignity of every person.

STRATEGIC INITIATIVES

The following initiatives are key to the University's achieving recognition as a premier Jesuit Catholic, urban university:

- { 1 } Recruit and retain a diverse faculty of outstanding teacher-scholars and a diverse, highly qualified, service-oriented staff, all committed to advancing the University's Visions, Mission and Values;
- { 2 } Enroll, support and graduate a diverse student body, which demonstrates high academic achievement, strong leadership capability, concern for others and a sense of responsibility for the weak and the vulnerable.
- { 3 } Provide an attractive campus environment and the resources to promote learning throughout the University:
 - Learning resources that improve the curriculum and support scholarship
 - Facilities to support outstanding educational programs
 - Technology solutions to enhance learning and improve service
- { 4 } Continue to strengthen the University's financial resources to support its educational mission.

Statement of ICEL's Mission

The Institute for Catholic Educational Leadership (ICEL) is a program designed to make a unique and significant contribution to the leaders, educators, students and parents who value Catholic education. ICEL's aims are threefold:

- to offer a scholarly educational program relevant for Catholic school personnel;
- to build a sense of community among the students and faculty who pray together and serve others;
- and to prepare highly competent, effective, and dedicated educators for the Catholic schools.

This preparation of educators has two thrusts: academic programs and school community services. The academic thrust of the Institute is found in the degree and credential programs of the Catholic Educational Leadership Program (CEL), namely the Doctorate in Catholic School Leadership (60 units), the Master's in Catholic School Leadership (30 units), Master's in Catholic School Leadership with the Administrative Services Credential (36 units), the Master's in Catholic School Teaching (30 units), and the Master's in Catholic School Teaching with an Emphasis in Religious Education (40 units). The school community services provided by ICEL include: in-service training for faculties, symposia, conferences, workshops on current topics in Catholic education, presentations in schools and parishes, workshops for dioceses, and presentations at national conventions. The ICEL community publishes frequently and serves as an ongoing network for its graduates.

Catholic schools offer an alternative in a pluralistic society; they must be as strong as public schools if true democracy, which is dependent on an educated citizenry, is to survive. Because Catholic schools do not have the finances, the resources, or the numbers of their public school counterparts, their strength must come from excellent preparation and dedicated personnel. It is the University of San Francisco's goal to ensure both through its Institute for Catholic Educational Leadership.

ICEL/CEL Goals and Outcomes

GOAL: Students will become integrated leaders of Catholic education, which includes religious, spiritual, and moral competencies.

OUTCOMES

Students will:

- demonstrate an understanding of the vision, mission and values of Catholic education with the ability to communicate them to the various stakeholders of their schools.
- comprehend the foundations of Catholic education, inclusive of the components of Catholic identity.
- articulate Gospel values that are intrinsic to the Catholic faith.
- exemplify ethical decision-making as moral leaders.
- comprehend the stages of development in religious, spiritual, and moral development.
- demonstrate reflective practices in relationship to their religious, spiritual and moral growth.

GOAL: Students will become academically and professionally competent leaders in Catholic education.

OUTCOMES

Students will:

- demonstrate competency in coursework assignments.
- apply research skills to Catholic education and the field of education in general.
- apply best practice (research-based) pedagogy involved in Catholic school leadership at their local school sites.
- synthesize, apply and articulate educational research as a professional activity to enhance Catholic education.
- demonstrate reflective practices in relationship to their academic and professional growth.
- demonstrate understanding of the stages of human development, including the cognitive, affective, and social dimensions.

GOAL: Students will engage in a lifelong learning process and are the catalysts for lifelong learning in Catholic education.

OUTCOMES

Students will:

- demonstrate the knowledge and skills required within contemporary models of learning, which are characterized by transformative, reflective, and engaging modes of learning and higher order thinking.
- assess and integrate current technologies applicable to Catholic education.
- demonstrate the knowledge and skills necessary to the establishment of professional learning communities in their schools.

GOAL: Students will foster in their schools the four aims of Catholic education, namely, message, community, worship and service.

OUTCOMES

Students will:

- apply Gospel values within their school communities, for example, a knowledge of Catholic social teaching and the promotion of social justice.
- integrate *cura personalis* (“care for the person”) in their relationships with their stakeholders.
- demonstrate involvement in worship opportunities and foster such opportunities at their schools.
- demonstrate a commitment to service and foster service opportunities in their schools.
- engage in service learning activities.

GOAL: Students will seek to develop the essential personal skills of Catholic school leadership as modeled by Jesus Christ.

OUTCOMES

Students will:

- demonstrate respect for self and others.
- exhibit responsibility for self and to others.
- strive to develop healthy relationships with others, characterized by reverence and reconciliation.
- develop the openness to renewal of mind, body, heart and soul.

ICEL's History

The Institute for Catholic Educational Leadership was founded at the University of San Francisco in 1976 through the collaborative efforts of three nationally recognized scholars: Allen Calvin, then Dean of the School of Education at USF, Reverend Pierre Du Maine, then Superintendent of Catholic Schools in the Archdiocese of San Francisco (later Bishop of the Diocese of San Jose), and Michael O'Neill, then Superintendent of Catholic schools in the Diocese of Spokane, Washington (currently on the faculty of the College of Business and Professional Studies at USF). Each man had his own purposes for contributing to the design, but common among those reasons was the great need for a scholarly and ministerial preparation of Catholic educational personnel for its schools. Harold Buetow (*The Catholic School: Its Roots, Identity and Future* 1988; *Of Singular Benefit: The Story of U.S. Catholic Education*, 1970) wrote:

Today's Catholic schools need good leaders; the identity of our schools will suffer when its leaders do not understand the philosophical and historical backgrounds of the schools. These understandings need a special preparation. The shift away from special preparation of Catholic school principals and teachers by Catholic universities and colleges will eventually mean a loss of identity because no one will understand the principles that give a school its Catholic identity. (1988, p. 269)

Father Buetow was prophetic. In the early 1970s, some Catholic schools were beginning to suffer identity problems in much the same way as was the University of San Francisco. In the 1975 visit to USF by the Western Association of Schools and Colleges (WASC), the visiting committee wrote:

For a number of years the University has been in a state of transition from one in which "Catholics teach Catholics" to one in which a broader spectrum of backgrounds and attitudes characterizes both faculty and students. For many of the lay faculty, this change has been welcomed, and perhaps for some of the Jesuit faculty as well, but there remains a genuine concern by significant elements of the University community about how the Catholic character of the institution is to be manifested. The Committee found little to distinguish this institution from a secular college or university except for the symbolic clerical collars, occasional religious imagery, and the convenience and imposing presence of Saint Ignatius Church. Students and faculty remarked that the University had not found itself since the changes in church and campus life in the 1960s. (p. 1)

Dr. Agnes Jean Vieno, CSC, maintained in her doctoral dissertation, *The Institute for Catholic Educational Leadership: An Analysis of Student Expectations and Goal Achievement, 1976-1988* (USF, 1989), that the establishment of ICEL was, in addition to the reasons cited above, also a specific, though partial, response to the identity crisis of the University. Indeed, in many quarters of the Catholic school community throughout the United States, USF is known because of ICEL.

In 1975, O'Neill, who was to become the first director of the program, generated a needs assessment among the 741 Catholic elementary and secondary school principals in the state of California. The principals were asked to rank 37 previously expressed felt needs; the highest ranked needs were put into course designs. The goal was to offer high quality, with academic programs taught by the best instructors available in the Catholic school community at a relatively low cost. In other words, the ICEL design was to preserve the best of the educational model that had worked so well in preparing Catholic personnel of the '40s and '50s with the academic, community, and ecclesial issues of the '70s. Today, ICEL continues to update that needs assessment every year by asking students for new felt needs. Many of these requirements have been added to the curriculum through the elective program. The content of the core courses has changed, with moral development being added to the core in 1986.

O'Neill phrased the original goals in the following way:

The Institute for Catholic Education, a national prototype, is established to:

- Provide training for actual and/or potential administrators in Catholic (private) education, and to improve the educational practices in Catholic (private) schools;
- Encourage a support system among those participating in the program;
- Offer consultation and other services to Catholic (private) schools and Catholic (private) school systems;
- Influence leadership in Catholic education on the national level through scholarship and participation in national programs. (Brochure, 1976)

The Institute for Catholic Educational Leadership was formally inaugurated in June of 1976 (the M.A. program was approved by the Board of Trustees at its spring meeting in 1976) by hosting an invitational national symposium for 120 prominent Catholic school leaders from throughout the United States. It was a working group and it had as its theme the newly published research of Father Andrew Greeley, William McCreedy, and Kathleen McCourt (*Catholic Schools in a Declining Church*). The Symposium, held at the University of San Francisco, was featured in *Momentum Magazine* (October, 1976), which gave its entire issue over to publicizing the new Institute. In May, 1977, the Ed.D. program was approved by the Board of Trustees, making it the only program of its type in the country.

During the first year, ICEL courses and workshops were conducted in varying formats and lengths, and in several locations in California and across the country. The first fulltime faculty member was Father Patrick Duffy, a professor of law at the University of California at Berkeley, and now deceased. Other fulltime ICEL faculty and staffers were Sisters Francette Keillocker, Veronica Skillin, SNDdeN, and Mary Mark Golden, SNDdeN, and Robert Newton, S.J. At one time in the late 1970s, there were six fulltime staff members, in addition to the Director. There was also a secretary and an advisory board made up of leaders in private school education.

In 1978, Edwin J. McDermott, S.J., whose term as the first president of the Jesuit Secondary Educational Association in Washington, D.C., had expired, joined the team and became the Acting Director. When Michael O'Neill became Dean, Father McDermott then was named the second Director. Mary Peter Traviss, O.P., who had served as an adjunct professor until 1985 and, then, became a fulltime faculty member, was appointed as the third Director of ICEL in 1989. Raymond J. Verduyck, CFC, was named the fourth Director in 2004. Dr. Geoffrey R. Dillon S.J. was appointed Interim Director in 2009.

Dr. Don Erickson became part of ICEL when he was named to direct the Center for Research on Private Education. The Center was productive, if short-lived, and Dr. Erickson moved to the University of California at Los Angeles when funding became a problem.

In 1978, an off-campus program was started in the Archdiocese of Los Angeles in response to the urging of Monsignor John Mihan, Superintendent of Schools. Sister Clare Sanchez, SNDdeN, was appointed the first coordinator. Later, Sister Margaret Ann Nowacki, CSC, was put in charge of coordinating the program. In 1991, Dawn Cooper assumed this position and served until the end of the summer of 2000. In the fall of 2000, Joan Tyhurst assumed the duties of coordinator. In the Spring of 2006, after 28 fruitful years, the Los Angeles program closed. In 1991, WASC approved an off-campus program for the Diocese of Honolulu, because of the promptings of then Associate Superintendent, Nora Santos, an ICEL graduate. That program met the needs of key personnel in Hawaii through a cohort of M.A. students.

In 1994, Dr. Gini Shimabukuro joined the ICEL team as a fulltime member of the faculty and served as Associate Director from 1997-2003. In 2003, she was elected Chair of the Department of Catholic Educational Leadership. Jeanne Hagelskamp, S.P., was named the Assistant Director in 1998, and was appointed to a three-year faculty term appointment in the fall of 2000. Shortly after, Sister Jeanne was appointed Director of Teacher Education with the understanding that she would also serve as an adjunct for ICEL. Miss Ailish Riggs was named Administrative Assistant in the summer of 2000.

In 1996, ICEL re-established its Advisory Board. Its initial membership consisted of the following individuals: Dr. Sharon Anderson; Charles Moutenot, S.J.; Mary Catherine Antczak, O.P.; Leonore Heffernan; Mary Claude Power, PBVM; Most Rev. John Cummins; Robert Teegarden; Lars Lund; Mrs. Noreen Murphy; Msgr. Robert McElroy; and Dominic Berardelli, FSC.

In 1999 the Jesuit Community of the University of San Francisco gave ICEL a \$2 million "Endowed Fund." The fund was given specifically to the Institute and not to the Department. It is used for outreach activities by the Institute, such as conferences, sponsorship of the journal, *Catholic Education: A Journal of Inquiry and Practice*, research activities, etc.

Father Schlegel, then President, matched the Fund with a commitment of the Ignatian Tuition Grant (ITG) at a \$320,000 level for ten years. Nonetheless, annual monies from foundations were needed to augment the ITG and allow a continuance of the 50% tuition grant. Beginning with the summer term, 2002, CEL students were given a reduced tuition status (by 50%). The announcement of this great gift to ICEL was made May 1, 2002. It reduced anxiety about exceeding the ITG and the possibility of a "catch 22" situation, afraid of accepting more students and subsequently run out of ITG funds. This assistance from USF was due largely to the efforts of Robert Niehoff, S.J. and Charles Cross, the Vice President of Business and Finance.

The following represents a summary of events sponsored by the Institute since the year, 2000:

- In response to a recommendation by the ICEL Advisory Board to provide a leadership role in Catholic school research, ICEL hosted a two-day Catholic School Research Summit for the purpose of planning a research agenda for the next century. The event took place on the Lone Mountain Campus from March 17-19, 2000.
- In April, 2000, ICEL sponsored a free-of charge workshop for the Catholic school principal and pastor teams of the Archdiocese of San Francisco, the first of three such workshops. The second one was held in 2001, and the final conference in 2003.
- ICEL has circulated its newsletter, the *ICEL Monitor*, to current students, faculty, and alumnae for 21 years.
- The year 2000-2001 marked the 25th anniversary of ICEL. It was celebrated with a variety of events, including a lecture series (Salt Lake City, Honolulu, Los Angeles, San Francisco), a Newman Symposium, the Greeley address and award, the Pastor/Principal Conference II, and the Leadership Conference, which it co-sponsored with USCC in June, 2001. The year also featured special street banners which were displayed in front of the School of Education, an anniversary leadership dinner, a special Christmas party, and an anniversary NCEA social.
- In June of 2001, ICEL hosted a conference for 40 nationally-recognized Catholic school educators. The purpose of the conference was to explore ways of preparing future leaders and ensuring the

continuance of Catholic schools. The proceedings were published in a magazine format and circulated throughout the American Catholic school community. A follow-up conference was held at the University of Dayton, Ohio.

- The year 2002-2003 witnessed a good deal of activity on the part of ICEL. The Institute hosted a June conference, entitled *Relationships: A Focus of Catholic Education for the New Century*, which Margaret Wheatley keyed. The Institute concluded the pastor-principal series. In addition, Ray Vercruysse, CFC, then one of the Merit scholars, designed a week long Secondary School President/Principal Conference, entitled *Growing and Developing: The Catholic Secondary School Presidency*, which was held during SummerWest of 2003.
- During SummerWest 2004, the Secondary School President/Principal Conference was continued at the University of St. Louis; during SummerWest 2005, this Conference was held at The Catholic University of America.
- During SummerWest 2006, the fourth President/Principal Conference and the first Superintendents Academy was held at the Radisson Hotel in Brisbane, CA.
- During SummerWest 2007, the fifth President/Principal Conference was offered in collaboration with the University of Rochester, New York.
- During SummerWest 2009, the seventh President/Principal Conference was held at the Hyatt Fisherman's Wharf, San Francisco, CA.
- In the Fall 2009, the *ICEL Monitor* was reformatted into electronic format.

The CEL/ICEL Student

As was noted in the history of ICEL, the Institute was designed around the assumption that community building would occur in a program of higher education when the student-educators prayed, played, and studied together. This has remained an enduring premise in the history of ICEL's existence. However, just as the American Bishops later added "Worship" to the three component parts of Catholic education-- Message, Community, and Service --so over the years ICEL has added Service to Prayer, Study, and Recreation.

How do ICEL students live out these component parts of ICEL? They have done so in many creative ways. These are a few that have been observed:

Praying Together

Prayer time is scheduled over the six weeks to come together to celebrate as a faith community committed to bettering Catholic Education. During the summer, one day a week is designated as a time to celebrate Eucharist together. Students are encouraged to set that time aside as an important time to join in community prayer. This will be followed by time to relax and socialize together.

Throughout the year, special occasions are often celebrated with Eucharistic Liturgies or other liturgical services. These gatherings occur during the day and are significant to the ICEL community. All ICEL members are invited to participate in these liturgical experiences.

All CEL classes begin with prayer. Students may wish to join a prayer group with other CEL students. In addition, there is a section of the bulletin board in the ICEL hall devoted to prayer requests. Please make an effort to include special requests in that area.

The existence of God is a unifying reality in the ICEL community. ICEL is a believing community and that makes a difference in the way students approach their studies, participate in discussions, make presentations and applications, and plan implementations. It does make a difference that students are taking educational theory to the marketplace of the school that is also a believing community.

Studying Together

Because study enhances the ability to engage in the apostolate of education with heightened competencies, it is important that CEL students be generous in sharing knowledge. It has been frequently noted that CEL students do not hoard books but pass them around; they take notes for one another and work on projects together; and they share insights and exchange perceptions. When they differ with one another it is done with respect and the desire to expose the truth, so much a part of the ICEL mission.

Students often form informal study groups. They have even been known to set up telephone, e-mail, and communication contacts to discuss classes and share information gained from reading. Each semester there is a doctoral sharing group (topics, progress, methodology, ideas for further research, etc.). Cooperative learning and collaborative study are essential to a truly scholarly community based on the concept of the Christian family.

Socialize Together

This third prong of the ICEL experience is perhaps the one most frequently mentioned by alumni/ae, and that is the friendships that are made in ICEL which often begin with simply enjoying one another's company. The friendships deepen through prayer, working together in service projects, and study, but it is the social time that students share that shapes the initial relationship. These friendships have blossomed into professional bonds that impact on ministry and indeed on one's life.

One has only to observe the interaction of thirty-plus years of alumni/ae together at the annual NCEA social to believe the depth of many of these ICEL forged relationships. In the past, organized weekend jaunts, picnics, visits to the wine country, barbecues, city tours, workouts at the Koret Center, hikes, or dinner and a movie together have occurred during SummerWest.

Service

In Luke 6:38, there is the image of goodness "being pressed down and running over" and shared with others. Our Lord frequently encourages his disciples to do "good works." ICEL believes that the ICEL experience must be shared with others in the apostolate of schooling--at whatever level in which the person is involved.

In that spirit, it is suggested that students offer service on behalf of ICEL. During the summer there are numerous tasks and projects (often of a different kind than those during the year) which are available through the ICEL office.

Offices and CEL/ICEL Staff

The Institute for Catholic Educational Leadership (ICEL), the Catholic Educational Leadership Program (CEL), and faculty offices are located on the 2nd level of the School of Education.

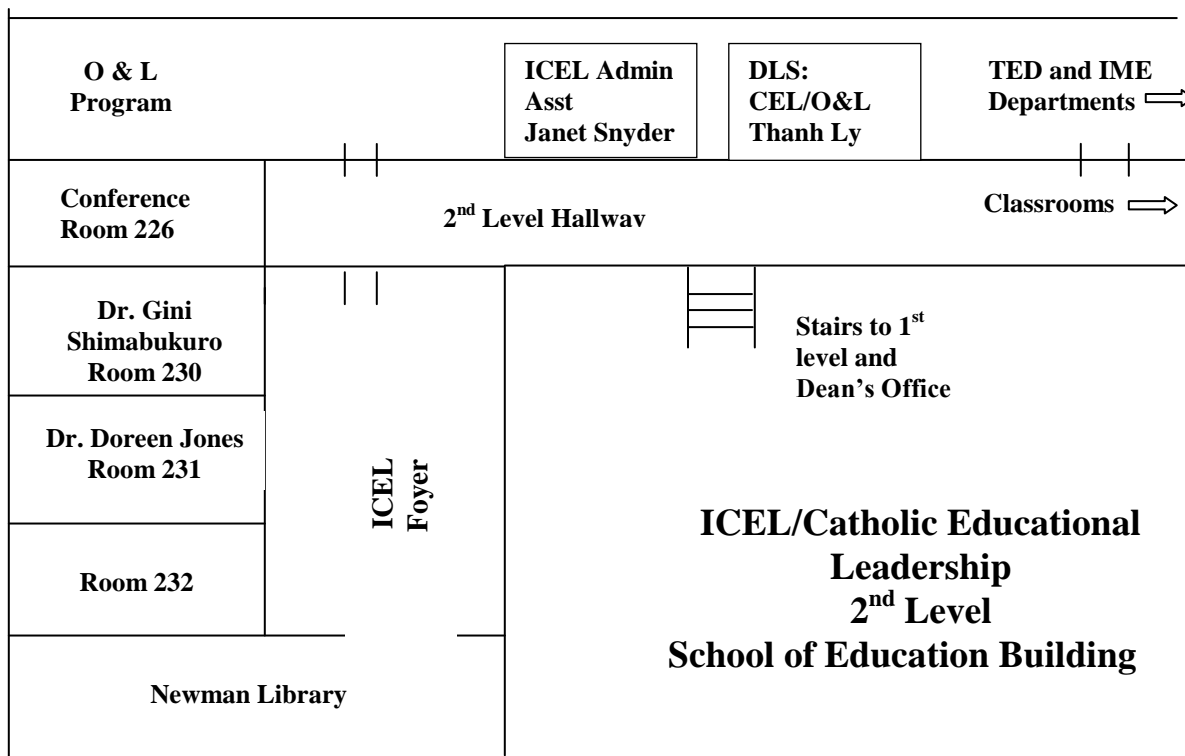

Dr. Geoffrey R. Dillon, S.J.

Interim Director, Institute for Catholic Education Leadership (ICEL)
 Catholic Educational Leadership (CEL) Program
 Chair & Director of Field Placements, Teacher Education Department
 Director, *Project Learn Belize*

A.B., Spring Hill College, 1975; Ed.M., Harvard University, 1979; M.Div., Weston School of Theology, 1983; C.A.S.,
 Andover-Newton, 1984; Ed.D., University of San Francisco, 1997

Dr. Gini Shimabukuro (1994-)

Associate Professor, Catholic Educational Leadership Program. Teaches Curriculum and Instruction Leadership;
 Spirituality of the Educator; Scholarly Writing for the Dissertation; Dissertation Proposal Seminar; Dissertation
 Proposal Development; Dissertation Research and Writing; Directed Studies.

B.A., Loyola University of Chicago, 1970; M.A., San Francisco State University, 1987; Ed.D., University of San
 Francisco, 1993.

Dr. Doreen Jones

Adjunct Professor. Teaches Moral Development; Methods of Educational Research; Introduction to Doctoral
 Research; Dissertation Proposal Development; Dissertation Research and Writing.

B.A., Holy Names College, Oakland, 1967, M.A. University of San Francisco, 1995, Ed.D., University of San
 Francisco, 2000.

Thanh Ly, Department of Leadership Studies (CEL/O&L) Program Assistant

Janet Snyder, ICEL Administrative Assistant



Important Phone Numbers

CEL/ICEL

Dr. Geoffrey R. Dillon, Interim Director	ED 207	415-422-5489
Dr. Doreen Jones, Faculty	ED 231	415-422-5891
Dr. Gini Shimabukuro, Faculty	ED 230	415-422-6934
Ms. Janet Snyder, Administrative Assistant	ED 210	415-422-2083
Ms. Thanh Ly, Program Assistant	ED 210	415-422-6226
CEL/ICEL FAX #		415-422-5526

dillon@usfca.edu
jonesdf@usfca.edu
shimabukurog@usfca.edu
snyderj@usfca.edu
tnyl@usfca.edu

School of Education Departments & Offices

Dean's Office		415-422-6525
Counseling Psychology		415-422-6868
International and Multicultural Education		415-422-6878
Organization and Leadership Program		415-422-6551
Learning and Instruction		415-422-2099
Teacher Education		415-422-6481
Curriculum Resource Center		415-422-2292

Deans Office Hours

M-F: 9 am-5:30 pm
 TW Sat: 11 am – 1:30 pm
 Summer M-F: 9 am – 5:00 pm

Other SOE Building Resources

Center for Instruction and Technology		415-422-2223
Club-ED		415-422-5957

Our Address

Mailing address:
 USF - ICEL
 2130 Fulton Street
 San Francisco, CA 94117-1071

Other Campus Resources

Admissions		415-422-6563
Audiovisual (Lone Mountain campus)		415-422-6668
Bookstore		415-422-6493
ONE-STOP (Registrar, Bursar and FinAid)		415-422-2020
Counseling and Psychological Services		415-422-6352
Information & Technology Services		415-422-6668
General USF Information		415-422-5555
Gleeson Library		415-422-2660
Reference Department		415-422-2039
Koret Center		415-422-6821
Public Safety (non-Emergency and Business)		415-422-4222
24-Hour Emergency		415-422-2911
Registrar (One Stop)		415-422-2020
Residence Life		415-422-6824
Gillson		415-422-6183
Hayes-Healy		415-422-6444
Lone Mountain		415-422-6845
Phelan		415-422-6626
Loyola Village		415-422-5521

Street address:
 (for cab pick up/drop off or food delivery only...do not send mail to this address)
 2350 Turk Boulevard

Our Website

<http://usfca.edu/icel>

The ICEL Monitor

Send news or sign up for the ICEL newsletter

icelmonitor@usfca.edu

Catholic Educational Leadership (CEL) Programs

Master of Arts in Catholic School Teaching

The following are the core requirements for the M.A. in Catholic School Teaching:

- CEL-640 **HISTORY AND PRINCIPLES OF CATHOLIC EDUCATION (3 Units)**
Analysis and discussion of historical, philosophical, theological, sociological issues in American Catholic education.
- CEL-642 **MORAL DEVELOPMENT (3 Units)**
Study of the major theories, research, materials and methods related to moral education, with particular emphasis on the dynamics of the Catholic school classroom.
- CEL-644 **CURRICULUM AND INSTRUCTION LEADERSHIP IN CATHOLIC SCHOOLS (3 Units)**
Models, research, and practical applications of design and evaluation of curriculum and instruction. Development of a curriculum model for a particular private school.
- CEL-646 **METHODS AND MATERIALS IN TEACHING RELIGION IN CATHOLIC SCHOOLS (3 Units)**
A study of the current context of Religious Education: qualities and competencies of religious educators, review of the Basic Teachings of the Church and Church History and their incorporation into a graded catechesis based on child development, liturgy, ethnic influences, along with prayer, community building, and service.
- CEL-648 **SPIRITUALITY OF THE EDUCATOR (3 Units)**
Spirituality of leadership for the teacher in Catholic schools drawn from history of both spirituality and education. The main themes will be developed from the four Constitutions of the Second Vatican Council.
- CEL-690 **M.A. CULMINATING PROJECT (3 units)**
A project to stimulate the integration of knowledge and skills gained from the M.A. program, which is submitted as a formal report in partial fulfillment of the master's degree.

In addition to the core requirements listed above, the following courses from the Teacher Education Department are required for the Master's program in Catholic School Teaching:

- TEC-610 **LEARNING AND TEACHING (3 units)**
Application of theories and principles of learning, motivation, social behavior, human development, individual differences, and educational measurement to the analysis of instructional problems in school settings. May require fieldwork outside of class time at an approved school site, arranged with course instructor.

A Curriculum and Instruction course from the Teacher Education Department, which would be satisfied by any one of the following Teacher Education (TEC) offerings:

- TEC-612 Multiple Subject Curriculum and Instruction: Reading & Language Arts in the Intermediate Grades
- TEC -613 Multiple Subject Curriculum and Instruction: Math & Science
- TEC -621 Multiple Subject Curriculum and Instruction: Early Literacy
- TEC -630 Multiple Subject Curriculum and Instruction: Social Studies
- TEC -615 Single Subject Curriculum and Instruction: Math & Science
- TEC -617 Single Subject Curriculum and Instruction: Teaching Field
- TEC -628 Single Subject Curriculum and Instruction: English
- TEC -629 Single Subject Curriculum and Instruction: Social Science

The core requirements for the M.A. in Catholic School Teaching consist of 24 units, with six units of electives remaining.

Master of Arts in Catholic School Teaching with a Concentration in Religious Education

The following represents the course of study for the M.A. in Catholic School Teaching with an Emphasis in Religious Education. This master's degree consists of 40 units of required coursework.

- CEL-662 CURRICULUM AND INSTRUCTION FOR RELIGIOUS EDUCATION (3 Units)
Study of scope and sequence, pedagogical approaches, methods, materials, and media appropriate for teaching Religious Education within the school curriculum. Course will survey the qualities and competencies of effective religion teachers. Participants will explore various methods for developing learning outcomes, assessment tools, instructional design and delivery, integration of educational technology, and strategies for classroom management.

- CEL-648 SPIRITUALITY OF THE EDUCATOR (3 Units)
Spirituality of leadership for the teacher in Catholic schools drawn from the history of both spirituality of education. The main themes will be developed from the four Constitutions of the Second Vatican Council.

CHRISTIAN DOCTRINES IN HISTORICAL DEVELOPMENT (3 Units)
A study of the major doctrines as they have developed through history: God as one and triune; Jesus; God and humanity; original sin; redemption; grace; the Church.

- CEL-642 MORAL DEVELOPMENT (3 Units)
Study of the major theories, research, materials and methods related to moral education, with particular emphasis on the dynamics of the Catholic school classroom.

- CEL-640 HISTORY AND PRINCIPLES OF CATHOLIC EDUCATION (3 Units)
Analysis and discussion of historical, philosophical, theological, and Sociological issues in American Catholic education.

- TBA TEACHER MENTORSHIP I, II, III (1 Unit Each, Totaling 3 Units)
Fulltime classroom Religious Education teaching and other related school activities carried out under the supervision of a cooperating teacher and a university supervisor. Includes on-campus seminars.
- TBA SCRIPTURAL CATECHESIS (3 Units)
Study of the basic methods and principles of Catholic biblical interpretation. Course will examine the major stories of Old and New Testaments. Participants will study effective catechetical methods for teaching Scripture in an accurate and pastorally appropriate manner. Course will conclude with an examination of various ways of using scripture in the classroom as a means of leading students in prayer and reflection.
- TBA CATHOLIC SACRAMENTS AND LITURGY (3 Units)
An overview of the history and practice of the Catholic sacraments from New Testament times to the present. Special emphasis will be given to Church teachings regarding the nature of the Sacraments, Christian worship, and the Liturgical Year. Participants will explore and practice the fundamentals of Catholic worship as they pertain to liturgical celebrations with students.
- TBA EDUCATIONAL LEARNING THEORY (3 Units)
A survey of various secular and catechetical methods of student learning and effective instructional methods. Participants will examine major cognitive theories and research on student thinking and motivation at appropriate developmental levels. Special emphasis will be given to Multiple Intelligence Theory and its application to religious education. Course will conclude with an exploration of the role of Catholic Education in the 21st Century.
- TBA CATHOLIC MORAL THEOLOGY AND SOCIAL TEACHINGS (3 Units)
A study of the basic principles of moral theology: Christian anthropology, human freedom, conscience, virtue, sin, grace and justification, the moral law (natural law and the teachings of Christ), and Catholic social teachings. Effective application of these topics in the classroom will be examined and practiced. Participants will review the major principles of student moral cognition and reasoning as well as specific moral issues students face today. The course will conclude with an overview of basic counseling principles of pastoral ministry.
- CEL-643 RELIGIOUS EDUCATIONAL LEADERSHIP (2 Units)
Analysis and discussion of effective ways to organize, evaluate, and improve religious education in church-related schools. Specific questions of staff development are addressed.
- CEL-690 M.A. CULMINATING PROJECT (2 Units)
A project to stimulate the integration, knowledge and skills gained from the M.A. program, which is submitted as a formal report in partial fulfillment of the master's degree.
- CEL-680 SEMINAR IN RELIGIOUS EDUCATION (3 Units)
Study and discussion of selected topics in religious education.
- CEL-645 JUSTICE IN THE SCHOOL CURRICULUM (3 Units)
Study of the social teachings of the Catholic Church with applications to curriculum design. Educational theory and sociological perspectives are integrated.

Master of Arts in Catholic School Leadership

The following are the core requirements for the M.A. in Catholic School Leadership:

- CEL-640 HISTORY AND PRINCIPLES OF CATHOLIC EDUCATION (3 Units)
See description above.
- CEL-642 MORAL DEVELOPMENT (3 Units)
See description above.
- CEL-641 PRIVATE SCHOOL LAW (3 Units)
Analysis of principal legal and constitutional issues in federal and state law affecting Catholic educators, including liability, contract law, and major church-state rulings.
- CEL-644 CURRICULUM AND INSTRUCTION LEADERSHIP IN CATHOLIC SCHOOLS (3 Units)
See description above.
- CEL-650 CATHOLIC LEADERSHIP AND EDUCATIONAL ADMINISTRATION (3 Units)
Examination of significant theories and research in the management of educational organizations, leadership, change, administrative styles, decision making, and informal organization. Emphasis on the administrator as facilitator of dialogue by collaborating with diocesan boards, staffs, pastors, school boards, and parents.
- CEL-653 PERSONNEL LEADERSHIP IN CATHOLIC SCHOOLS (3 Units)
Leadership theory, research, and practical skills applied to such Personnel issues as communication, problem-solving, conflict resolution, supervision, hiring and staff development.
- CEL-690 M.A. CULMINATING PROJECT (3 Units)
A project to stimulate the integration of knowledge and skills gained from the M.A. program, which is submitted as a formal report in partial fulfillment of the master's degree.

The core requirements for the M.A. in Catholic School Leadership consists of 21 units, with nine units of electives remaining.

Culminating Project for the Master's Degree

Successful completion of a culminating activity is required of all Catholic Educational Leadership master's students prior to posting of the degree. The purpose of this activity is to stimulate students to integrate the knowledge and skills gained from their program's core areas (see note on p.39), as well as from the elective program, into the creation of a final project. This is accomplished through a 3-unit required course toward the completion of master's coursework.

Options for the M.A. Culminating Project

The following options are available to students, with the expectation that any of these will result in scholarly work representative of a master's student. It is anticipated that projects will range from 30-45 pages in length.

- I. A field project based upon the development of a project applicable to Catholic education;
- II. An action research project based in the student's own school (either administrative or instruction-related);
- III. A thesis involving the design and execution of a study in Catholic education (This option requires enrollment in the Research Methods (GEDU-603) course);
- IV. A portfolio, consisting of three refined core course practica that share a common theme and a written synthesis.

Required Style Manual

American Psychological Association. *Publication Manual of the American Psychological Association*. (6th Edition). Washington, D.C: American Psychological Association. Students should strive to write in an academic style characteristic of scholarly work.

Procedure

The student, early on, should decide upon the preferred type of culminating activity and subsequently solicit approval from his or her advisor. Students are expected to complete their projects within two years of enrolling in CEL-690. Failure to do so will result in notification from the Dean that completion of their M.A. degree is in jeopardy. The student should submit a velo-bound copy of the completed project to the department for faculty review no later than April 1 (for May graduation) or November 1 (for December graduation). Projects will be subsequently placed in ICEL's Newman Library.

Protection of Human Subjects

Every Culminating Project involving human subjects must have prior approval from the Institutional Review board for the Protection of Human Subjects (IRBPHS).

- 1) Detailed information regarding the Institutional Review Board for the Protection of Human Subjects (IRBPHS), including the IRBPHS manual and application can be found at the following URL: (<http://usfca.edu/soe/students/irbphs/>). Submit two copies of completed forms to the following address:

IRBPHS
University of San Francisco
Counseling Psychology Department
2130 Fulton Street
San Francisco, CA 94117

- 2) **Please note that approval could take up to one month, even when there are no significant delays.** Approval of an application is for one year only. If the project extends beyond one year, then a renewal application must be filed with the IRBPHS.

Option I: Field Project

The student who chooses this option must receive prior approval by the faculty for the selected project, which must be based in Catholic education. It should address the following structure:

Title Page

Table of Contents

Part I: Introduction

Provides a general overview of the focus of the project, with sufficient background that demonstrates the need for the project.

Part II: Review of Literature

Review of major research literature (minimum 10 works) that supports the educational value of the project.

Part III: Project Development & Implementation

Discussion of the development of the project, including the planning and development stages of the project, description of materials used or developed (to be included in Appendix), and implementation.

Part IV: Project Evaluation & Conclusions

Discussion of how project will be evaluated. (Any evaluation instruments to be used should be included with the project in the Appendix.)

References

Appendix

Option II: Action Research Project

Cohen and Manion (1996) defined action research as a “small-scale intervention in the functioning of the real world and a close examination of the effects of such intervention” (p. 186). Thus, students interested in this option for the culminating project may select an administrative or instructional problem in a Catholic school and address the following structure:

Title Page

Table of Contents

Part I: Introduction

Problem/Background/Research Questions

Identification, evaluation and formulation of the problem perceived as critical in an everyday Catholic school situation. “Problem” may be interpreted to refer to the need to introduce innovation into some aspect of a school’s established program. The introduction should provide background of the school situation as it relates to the problem. This section should include the statement of the question(s) to be investigated.

Part II: Review of Research Literature

Review of major research literature (minimum of 10 works) to find out what can be learned from related studies/projects, their objectives, procedures and problems encountered.

Part III: Selection of Research Procedures/Choice of Evaluation Procedures

Identification of the procedure to be implemented to investigate the research question(s). This should include a description of the population under study, methods and materials to be used in the execution of the study, and means to evaluate the data.

Part IV: Implementation of the Project

Description of the conditions and methods of data collection (e.g., monthly meetings, the keeping of records, interim reports, final reports, the submission of self-evaluation and group-evaluation reports, etc.); the monitoring of tasks; and the classification and analysis of data.

Part V: Interpretation of the Data

Drawing of inferences and overall evaluation of the project. Errors, mistakes and problems are considered.

Part VI: Conclusions

A general summary should review the outcomes of the project. Recommendations should be made.

References**Appendix**

Be sure to include instrumentation utilized in the study, as well as other pertinent documentation.

Option III: Thesis in Catholic Education

It is advisable that students, who wish to conduct a study in a thesis format, select a problem relevant to Catholic education and work under the close advisement of a faculty member. The thesis should contain the following structure:

Title Page**Table of Contents****Chapter I: Introduction**

Statement of the Problem

Background and Need for the Study

Purpose of the Study

Research Questions

Methods (research method, instrumentation, participants, pilot study, analysis of data)

Definition of Terms (if needed)

Limitations

Summary

Chapter II: Review of the Literature**Chapter III: Findings****Chapter IV: Discussion, Conclusions and Recommendations****References****Appendix**

Option IV: Portfolio Synthesis

The student who selects this option will include three practica/projects from three core areas that he or she determines to be particularly relevant to the future of Catholic education. It is expected that these practica will have been refined and expanded for full implementation in a Catholic educational setting and will exhibit a common theme. The accompanying synthesis paper should contain the following structure:

Title Page

Table of Contents

Part I: Introduction

Description of contents of portfolio, that is, the three practica, and rationale for selection.

Part II: Catholic Philosophical and Theological Foundations

Discussion of Catholic philosophical and theological foundations that advocate the design and implementation of the three practica.

Part III: Current Literature

Review of current educational theory and research (minimum of 10 works) that support the educational value of the practica.

Part IV: Assessment

Consideration of methods of assessment. If already implemented, discussion of strategies incorporated to assess intended outcomes and their results, noting revisions made for future practice. If not yet implemented, identification of assessment strategies.

References

Appendix

Note: The core areas for the M.A. in Catholic School Leadership are: Ecclesial Principles of Catholic Education, Leadership & Administration, Personnel Leadership, Curriculum & Instruction Leadership, Moral Development, and School Law. For the M.A. in Catholic School Teaching, the core areas are: Ecclesial Principles of Catholic Education, Curriculum & Instruction Leadership, Moral Development, Spirituality of the Educator, Methods & Materials in Teaching Religion, Learning and Teaching (TED), and one additional Curriculum and Instruction course (TED).

Certificate of Advanced Studies (CAS) in Catholic Educational Leadership

This 12-unit program is specifically designed for Catholic school leaders who already have a master's degree. Those whose degree is in educational administration from a secular university would gain a distinctly Catholic perspective. Those whose master's is in a subject area other than educational administration would benefit from the program as well. Post-master's units may be applied to the doctoral program. Required courses include:

- CEL-641 PRIVATE SCHOOL LAW
See description above
- CEL-640 HISTORY AND PRINCIPLES OF CATHOLIC EDUCATION
See description above
- CEL-650 CATHOLIC LEADERSHIP AND EDUCATIONAL ADMINISTRATION
See description above
- CEL-651 BUSINESS AND FINANCE FOR CATHOLIC SCHOOLS
This course examines the role of the president/principal as leader in the area of accounting, budgeting, financing, planning, fund raising and business management for Catholic schools.

California Preliminary Administrative Services Credential

CEL collaborates with the Organization and Leadership Program to provide a California Preliminary Administrative Services Credential to those students who possess a Certified State Teaching Credential and who are working toward their M.A. in Catholic School Leadership. At the beginning of the master's or doctoral program of studies, students should meet with their advisors to establish a study plan integrating the credential with their degree coursework. Students should file an application for admission to the credential program with the Dean's Office, as well as set up an appointment with the Coordinator of the Administrative Credential Program to discuss the credential requirements. The Preliminary Administrative Services Credential is composed of nine courses (27 units), four of which are ICEL offerings:

- CEL-650 CATHOLIC LEADERSHIP AND EDUCATIONAL ADMINISTRATION (3 units)
See description above.
- CEL-644 CURRICULUM AND INSTRUCTION LEADERSHIP IN CATHOLIC SCHOOLS (3 units)
See description above.
- CEL-653 PERSONNEL LEADERSHIP IN CATHOLIC SCHOOLS (3 units)
See description above.
- CEL-651 BUSINESS AND FINANCE FOR CATHOLIC SCHOOLS (3 units)
See description above

(Continued)

The five non-CEL courses, offered through the Organization and Leadership Program, pertain to specific domains of content and competence and include 6 units of supervised field experience:

- O&L-654 SCHOOL, COMMUNITY AND SOCIETY (3 units)
This course focuses on the following areas: roles of the school, parents and community in the educational process; economic, socio-cultural and political aspects of school community relations; concepts for authority, power, and influence; roles of federal, state, and local agencies and professional organizations.
- O&L-622 EDUCATION LAW
A survey of the American governmental structure with its levels of law and authority systems is applied to primary and secondary education. The topics covered are: (1) parental role in the education of minor children; (b) educational policy and its enforcement; (c) church/state issues in public and private schools; (d) state and local educational bodies, their governing authority and practices; (e) topics in tort liability; (f) educational law and educational professionals; (g) educational law and the minor student; (h) race and disability issues in primary and secondary education.
- O&L-615 INFORMATION SYSTEMS IN EDUCATIONAL MANAGEMENT (3 units)
This course examines the uses of information in the management of educational institutions and issues administrators face in the management of this information including collection, storage, and dissemination. Focuses on integration and communications of information for decision-making. Includes an introduction to validity and reliability in tests and measurements; use of specific tools, such as school schedulers and pupil records; and human, technological, and legal issues in sharing information. Students will work in teams to develop “hands-on” projects. Prerequisite: Ability to use any personal computer for word processing or other tasks.
- O&L-648 FIELD EXPERIENCE I (3 units)
- O&L-649 FIELD EXPERIENCE II (3 units)

California Clear Administrative Services Credential

The Clear Administrative Services Credential requires the successful completion of the following 12 semester credits of course work:

- O&L-731 POLITICS OF EDUCATION (2 Units)
- O&L-732 DATA, ASSESSMENT & CURRICULUM (2 Units)
- O&L-736 URBAN SUPERINTENDENT (2 Units)
- O&L-737 PRESSING URBAN ISSUES (2 Units)
- O&L-738 ADVOCACY, MEDIA & LAW (2 Units)
- O&L-733 PROFESSIONAL PRACTICE OF EDUCATIONAL LEADERSHIP A (1 Unit)
- O&L-734 PROFESSIONAL PRACTICE OF EDUCATIONAL LEADERSHIP B (1 Unit)

California Teaching Credential/M.A.

The University of San Francisco offers a credential/master's option for Catholic school teachers who wish to earn a California preliminary credential, specially designed to serve the needs of Catholic school educators in the San Francisco Bay Area. The program, co-sponsored by the Teacher Education Department and the Catholic Educational Leadership Program, offers Catholic school teachers the opportunity to earn a California Single or Multiple Subject, CLAD or BCLAD Emphasis Preliminary Credential and a Master of Arts in Catholic School Teaching.

Courses Required for the Optional Master of Arts in Catholic School Teaching

For candidates who complete all teaching credential program requirements at USF, the M.A. in Catholic School Teaching may be obtained by successfully completing the following five core courses (15 units):

- CEL-640 HISTORY AND PRINCIPLES OF CATHOLIC EDUCATION (3 Units)
- CEL-642 MORAL DEVELOPMENT (3 Units)
- CEL-646 METHODS AND MATERIALS IN TEACHING RELIGION (3 Units)
- CEL-648 SPIRITUALITY OF THE EDUCATOR (3 Units)
- CEL-690 M.A. CULMINATING PROJECT (3 Units)

Doctor of Education in Catholic School Leadership

The doctoral program consists of 60 units, 12 of which are in the general education core (GEDU), 18 core and 6 elective units in the a major specialization (CEL), 12 units electives from CEL or other School of Education programs/departments, and 12 units in dissertation development, research, and writing. Consult the School of Education Doctoral Handbook for more detailed information on the doctoral program. For descriptions of all courses, please refer to USF Course Catalog.

General Education Core Requirements (12 Units): All students are required to complete 12 units in the General Education Core according to the following requirements (Gen Ed requirements cannot be satisfied by Directed Study or Transfer of Credit).

Required: The following 6 units are required of all students

GEDU-706	<i>Applied Educational Statistics</i> (3 units)
GEDU-708	<i>Research Methods in Education</i> (3 units)

Educational Foundations: Each student must take ONE of the following 3-unit courses:

GEDU-700	<i>Philosophical Foundations of Education</i>
GEDU-701	<i>Anthropology of Education</i>
GEDU-704	<i>Psychological Foundations of Education</i>
GEDU-705	<i>Law and Education</i>

Advanced Research Design Course: Each student must take ONE of the following 3-unit courses. Choice of course depends on the research design students will utilize in their dissertation study.

GEDU-710	<i>Analysis of Variance Designs</i>
GEDU-711	<i>Survey Research</i>
GEDU-712	<i>Qualitative Research in Education</i>
GEDU-713	<i>Content Analysis</i>
GEDU-714	<i>Educational and Psychological Measurement</i>
GEDU-715	<i>Anthropological Research in Education</i>
GEDU-716	<i>Program Evaluation</i>
GEDU-718	<i>Ethnicity and Multicultural Issues in Research</i>
GEDU-721	<i>Correlational Designs</i>
GEDU-722	<i>Meta-Analysis</i>
GEDU-723	<i>Participatory Critical Pedagogy Research</i>
GEDU-724	<i>Introduction to SPSS</i>

Major Specialization in Catholic Educational Leadership: Students are required to take a total of 24 CEL units (18 core units and 6 electives units)

Required: The following 18 units are required of all CEL students

CEL 740	<i>History and Principles of Catholic Education</i> (3 Units)
CEL 741	<i>Private School Law</i> (3 Units)
CEL 742	<i>Moral Development</i> (3 Units)
CEL 744	<i>Curriculum & Instruction Leadership in Catholic Schools</i> (3 Units)
CEL 750	<i>Catholic Leadership and Educational Administration</i> (3 Units)
CEL 753	<i>Personnel Leadership in Catholic Schools</i> (3 Units)

Additional Electives: Twelve (12) additional elective units may be taken from CEL courses, GEDU 725, and any other graduate program in the School of Education with the approval of the student's doctoral advisor.

Dissertation Requirements: The following 12 units are required of all doctoral students and are associated with the development, research, and writing of a doctoral dissertation.

CEL-700	<i>Introduction to Doctoral Research: Catholic Education</i> (3 Units)
CEL-709	<i>Dissertation Proposal Seminar</i> (3 Units)
CEL-790	<i>Dissertation Proposal Development</i> (3 Units)
CEL-791	<i>Dissertation Research & Writing</i> (3 Units)

Doctoral Portfolio Review Process

Initial admission to CEL doctoral program is a conditional one. To receive permanent status in CEL's doctoral program, students must complete CEL's four required portfolio courses, and submit CEL's four-part portfolio requirements to their doctoral advisor. The four required portfolio classes are to be the first 12 units students take in their CEL program. Students' portfolios will then be reviewed and evaluated by the CEL Portfolio Committee, who will then make its recommendation to the Dean concerning the students' future status in the program. After reviewing the recommendation of the committee, the Dean will send students a letter informing them of his decision, which could be that permanent status has been granted, permanent status is granted with conditions, or that permanent status has been denied. Students whose portfolios are not of passing quality may not continue to take course work and are not eligible to apply to another department.

The four CEL required portfolio courses are as follows:

CEL-700	Introduction to Doctoral Research: Catholic Education
CEL	Any CEL core course
GEDU-706	Applied Statistics
GEDU-708	Research Method

The four requirements for CEL portfolio are as follows:

- A current study plan
- A transcript showing the final grades received for the four portfolio courses
- A three to five page literature review pertinent to the student's doctoral topic or topic of choice
- An essay relative to: 1) student's reasons for pursuing a doctorate, and 2) the perceived contribution(s) the study would make to Catholic educational research.

Portfolio due dates will be announced each semester.

Portfolios are to be submitted in hard copy to the Doctoral Advisor. Portfolios will not be returned to students.

Academic Guidelines and Requirements

Students should consult the School of Education *MA* or *Doctoral Student Handbook* for a more detailed outline of policies. Many of the forms described below may be obtained by visiting the School of Education website: <http://usfca.edu/soe/>

Advising/Study Plan

Dr. Gini Shimabukuro is advisor to the M.A. students and Dr. Doreen Jones is advisor to the doctoral students. It is required that all CEL students create and file a complete study plan with their advisor. Students should refer to this plan when contacting their advisor. All MA and doctoral students are to meet with their advisor **each semester** to review and update their study plans so that they are kept both current and accurate.

Course Registration

Students register online once they have received the approval of their advisor for the courses they wish to take. Students use their USFconnect account to register online. For Doctoral students, dissertation courses must also be authorized by the Doctoral Program Assistant prior to registering.

Attendance Policies

Students should discuss any need for absence from class with the instructor. In all instances, students are responsible for contacting the instructor and completing work missed due to absence. If students know before registering that they must miss more than two classes, they are advised to take the course at another time.

Transfer Units

Students may transfer up to 6 graduate units into the M.A. program (12 for the doctorate) from Education, Theology, or Religious Education if the courses are related to the current areas of study, the units have not already been applied toward another graduate degree, and were taken within the past seven years, with a minimum grade of B. These transfer units must be approved by the student's advisor and the Associate Dean. Transfer forms are available in the program areas or the Dean's Office. A copy of the page of the university/college catalog description of the course(s) being transferred must accompany the form and an official transcript must be sent to the School of Education.

Petition to Enroll at Another Institution (PEAI)

Students who wish to take a course at another college or university while earning a degree at USF may do so upon completion of a *Petition to Enroll at Another Institution* (PEAI) form and approval from the Dean's Office. Under normal circumstances, the course must be one not offered by USF. CEL doctoral students may petition to take a class that will contribute to their dissertation in a significant way. Students may not take CEL core courses at another university.

Directed Study

Directed studies must be developed in consultation with a full-time faculty member; the learning objectives must be clearly defined, the nature of outcomes described, and a specific schedule of meetings with the professor established to obtain the guidance required. Directed studies may not be used to substitute for courses regularly provided in the curriculum. Masters students may earn up to 6 units of directed study and doctoral may earn up to 9 units. Use the *Directed Study Registration* form.

Course Waiver

A waiver of a core course excuses the student from a particular required course, but not from the total units required for a degree. Foreign students are often excused from taking School Law if they will not use it in their ministry. A waiver form must be filled out by the advisor and approved by the Dean. This form is not issued to students.

Declaring a Minor

Minors are usually reserved to doctoral students. However, a master's student may take a minor with the advice and consent of his or her advisor, and an advisor in the minor area in any program in the School of Education. CEL doctoral students may have minors in other departments within the School of Education. At least 12 units must be taken in the minor area. Students must file a *Petition to Declare a Minor* with the Dean's Office.

Scholarships and Grants

Limited scholarships are offered through the Dean's Office, but they generally cover the fall and spring semesters, and not the summer. Graduate Merit Assistantships are awarded annually through the Dean's Office. Interested applicants may contact Ms. Barbara Hood (hood@usfca.edu ; 455-422-5110). Additional inquiries may be made at Financial Aid in the One-Stop Office (Lone Mountain).

Special Student Status

Special Student Status is for students who have not formally applied to the CEL degree programs. Ordinarily students may not register for Special Students Status for more than two semesters, nor may they accumulate more than twelve units of credit. Special Student Status does receive reduced tuition. International students cannot apply for Special Student Status.

Grading Policy

Instruction in the various courses for each program is offered either by full-time faculty members in the School of Education or by highly qualified adjunct instructors, many of them practitioners in the field. Students are expected to attend all classes, participate fully in class activities, and to fulfill, in a scholarly and professional manner, the requirements of each course. Students must maintain a "B" average in all work undertaken in the degree and credential programs of the School or be subject to academic probation. The grading policy of the School is designed to provide feedback on the quality of the student's work. Symbols A, B, C, F, I, and IP are used in grade reporting as defined below:

- A (+/-)** Distinguished, clearly superior work showing high quality of insight, depth of knowledge, and with no fundamental deficiencies
- B (+/-)** Fully acceptable acquisition of basic subject and/or skill mastery.
- C (+)** Does not show graduate level mastery of the full range of knowledge and skills; the course must be repeated.
- F** Inadequate work, the absence of work or plagiarized work.
- I** An Incomplete (I) grade is only assigned when required student work is not completed before the end of the course, and there is a reasonable expectation that such work can be completed in a timely manner over the following semester. Incomplete grades may only be issued after consultation with, and approval by, the instructor. An Incomplete Grade/Course Completion Form must be filled out, signed by both the student and instructor, and submitted to the Dean's Office. Incomplete (I) grades will automatically be changed to a Failing (F) grade after one full semester unless the Incomplete Grade/Course Completion Form stipulates a

longer period of time. If the Incomplete Grade/Course Completion plan is not completed before the agreed upon deadline, the Failing (F) grade will stand, and the student must re-enroll in the course and pay tuition. **Students who exceed the maximum number of hours for absences in a course ARE NOT ELIGIBLE to receive an Incomplete grade** (see *Attendance Policies*, page 28).

- P** “Pass” (issued for courses that are graded on a Pass/Fail basis).
- IP** Work for the course is "In Progress" due to the nature of the particular course or course schedule. (Allowed only for Master’s Culminating Project, Dissertation Proposal Development, and Dissertation Research & Writing courses)
- W** "Withdrawal." A course dropped after the University census date.
- NR** Grade "Not Reported" by instructor within 15 days after the examination period. To correct the transcript the instructor must file a change of grade form. "NR" carries no connotation of student performance and no grade point value is given.
- RC** "Registration Canceled" put on transcript when the Bursar cancels registration due to nonpayment of tuition and fees.

Students who, because of the demands of their professional workload, anticipate problems in meeting timelines set by a particular instructor should discuss the problem in a timely and professional manner with the instructor. If a student has other course-related problems such as a difficulty with the classroom instruction or assignments, or disagreement with the instructor over grading, the issue should be discussed with the instructor.

Students whose cumulative grade point averages fall below 3.0 for any semester are put on academic probation.

Incomplete and In Progress Grades

An instructor may submit an “incomplete” if the student has not completed required work by the specified deadline. This “I” turns into “F” after one semester. Adjunct professors should fill out a special “Change of Grade” form at the time of issuing the “I,” so that it may be easily completed and turned in to the instructor when the student has completed the work. Students enrolled in 790 or 791 may be assigned an “IP” or “in progress.” This “IP” remains an “IP” on the report card until the instructor changes it. Instructors should fill out a special “Change of Grade” form when an “IP” is given.

Plagiarism

What is Plagiarism: Many people think of plagiarism as copying another’s work, or borrowing someone else’s original ideas. But terms like “copying” and “borrowing” can disguise the seriousness of the offense:

According to the *Merriam-Webster OnLine Dictionary*, to “plagiarize” means

- 1) to steal and pass off (the ideas or words of another) as one's own
- 2) to use (another's production) without crediting the source
- 3) to commit literary theft
- 4) to present as new and original an idea or product derived from an existing source.

In other words, plagiarism is an act of *fraud*. It involves both **stealing** someone else’s work and **lying** about it afterward.

But can words and ideas really be stolen?

According to U.S. law, the answer is yes. In the United States and many other countries, the expression of original ideas is considered intellectual property, and is protected by copyright laws, just like original inventions. Almost all forms of expression fall under copyright protection as long as they are recorded in some media (such as a book or a computer file).

All of the following are considered plagiarism:

- turning in someone else’s work as your own
- copying words or ideas from someone else without giving credit
- failing to put a quotation in quotation marks
- giving incorrect information about the source of a quotation
- changing words but copying the sentence structure of a source without giving credit
- copying so many words or ideas from a source that it makes up the majority of your work, whether you give credit or not (see our section on “fair use” rules)

Attention! **Changing the words of an original source is *not* sufficient to prevent plagiarism.** If you have retained the essential idea of an original source, and have not cited it, then no matter how drastically you may have altered its context or presentation, *you have still plagiarized*

Most cases of plagiarism can be avoided, however, by citing sources. Simply acknowledging that certain material has been borrowed, and providing your audience with the information necessary to find that source, is usually enough to prevent plagiarism.

“What is Plagiarism?” provided by Turnitin.com and Research Resources. Turnitin allows free distribution and non-profit use of this document in educational settings.

USF Honor Code

I. Purpose

As a Jesuit institution committed to *cura personalis*—the care and education of the whole person—USF has an obligation to embody and foster the values of honesty and integrity. USF upholds the standards of honesty and integrity from all members of the academic community.

II. The Honor Pledge

USF students uphold the Honor Code by adhering to the core values of the university and upholding its mission to guide their academic careers and educational experiences. (All students entering USF sign the following Honor Pledge)

USF Academic Honor Pledge

I pledge to demonstrate the core values of the University of San Francisco by upholding the standards of honesty and integrity, excellence in my academic work, and respect for others in my educational experiences, including supporting USF’s mission.

III. Standards of Conduct

Adherence to standards of honesty and integrity precludes engaging in, causing, or knowingly benefiting from any violation of academic integrity. Without regard to purpose, the following violations are prohibited.

A. Cheating

Cheating is the use or attempted use of unauthorized materials, information, and study aids, as well as unauthorized collaboration on examinations and other academic exercises. It is the responsibility of students to consult with their professors concerning what constitutes permissible collaboration. Cheating or helping others cheat is academic fraud.

B. Plagiarism

Plagiarism is the act of presenting, as one's own the ideas or writings of another; plagiarism, in any of its forms, violates academic integrity. While different academic disciplines have different norms of attribution, all strive to recognize and value individuals' contributions to the larger body of knowledge. It is the responsibility of students to consult with their professors in order to understand the norms of attribution in each discipline and area of study.

C. False Citations

False citation is attribution to an incorrect or fabricated source; false citation is academic fraud. False citation seriously undermines the integrity of the academic enterprise.

D. Submitting the Same Work for Multiple Assignments

Students may not submit work (in identical or similar form) for multiple assignments without the prior, explicit approval of all faculty to whom the work will be submitted. This includes work first produced at USF or at another institution attended by the student.

E. Submitting False Data

False data is information that has been fabricated, altered, or contrived in such a way as to be misleading; the submission of false data is academic fraud.

F. Falsifying Academic Documentation

Forging or altering academic documentation (including transcripts, signatures, letters of recommendation, certificates of enrollment or standing, registration forms, and medical certifications) concerning oneself or others is academic fraud.

G. Abuse of Library Privileges

Depriving others of equal access to library materials constitutes a violation of academic integrity. This includes sequestering library materials for the use of an individual or group, refusal to respond to recall notices, and the removal or attempt to remove library materials from any University library without authorization.

H. Abuse of Shared Electronic Media

Depriving others of equal access to shared electronic media used for academic purposes constitutes a violation of academic integrity. This includes actions that result in the damage or sabotage of campus computer systems.

For more information, visit <https://www.usfca.edu/catalog/policies/honor/>

Transcripts

Students may access their unofficial transcript through their USFconnect account. They may also order an official copy from the registrar for a small fee.

Instructor Evaluations

Students evaluate professors on a University-initiated survey at the end of each course. Additionally, students are asked to evaluate the SummerWest program each year. This evaluation is instrumental in designing future SummerWest programs.

Please do not wait for evaluation forms to provide feedback. It is important to know both strengths and weaknesses, particularly weaknesses, as soon as they become evident.

Petition to Graduate

Students must fill out a *Petition to Graduate* form online at <http://usfca.edu/Graduation/Students/Students/> before February 1 for a May graduation or September 1 for a December graduation. Consideration should be given on how the student's name appears on the diploma. Once the petition has been submitted, the name will be included in the commencement program. The student will be sent appropriate notices regarding the graduation, regalia, and invitations.

Graduation and Diploma

The diploma is mailed by the Graduation Center of the One-Stop Office after fulfillment of the degree requirements has been verified and all outstanding balances (tuition, fees, library fines, etc.) have been paid. The verification and processing of the diploma may take several weeks. One-Stop is located in Lone Mountain 251, phone (415) 422-2020.

Degrees are posted for the date (December or May) which follows the completion of all degree requirements. Transcripts may be ordered online.

Additional Academic Guidelines and Requirements for CEL Doctoral Students

Doctoral students should consult the current *Doctoral Student Handbook*, published through the Dean's Office. *The Doctoral Student* handbook provides comprehensive material on doctoral academic policies, research procedures and guidelines, services available, as well as additional valuable information for the doctoral student.

Full Admission to the Doctoral Program

The Catholic Educational Leadership requirements are as follows:

1) Successful completion of the following four courses (12 units):

CEL-700	Introduction to Doctoral Research
GEDU-706	Applied Educational Statistics
GEDU-708	Research Methods in Education
CEL-7xx	Any CEL core course

2) Review by the CEL faculty and approval of the Associate Dean of a *Doctoral Admission Portfolio* (See p. 28)

Residency Requirement and Student Load

To meet the academic residency requirement for the doctorate students must register for two consecutive semesters with a minimum course load of six (6) units per semester. In other words, students must have two consecutive semesters of Full-time status prior to dissertation coursework. This coursework is exclusive of dissertation course units. Enrollment in Intersession does not count toward the residency requirement. Refer to the USF General Catalog for more information.

To meet the Student Load requirement, a doctoral student is classified as full-time if registered for six units. In the early and intermediate phase of the program, students should enroll for six to nine units a semester. The unit load for Intersession is three units. Concurrent registration for Summer Session is limited to six units. Students wishing to register concurrently for more than six units must obtain the approval of the Associate Dean. A doctoral student may register for a maximum of 12 units a semester.

A graduate student may not register for fewer than three units during the Spring or Fall semesters. Doctoral students who fail to register for at least three units each Fall and Spring Semester, and are not on an approved Leave of Absence, will be administratively withdrawn. The only exception to the three unit minimum enrollment is a one-unit registration in 790 or 791, which meets the minimum enrollment requirements for continued matriculation (see *Proposal and Dissertation Development, Research and Writing*).

Students must be registered during the semester in which all degree requirements are completed.

Dissertation

The doctoral dissertation is a work of original, independent research in an area of educational significance. In CEL, this piece of research must represent a contribution to the knowledge base in the field of Catholic education.

Pre-Proposal Defense Meeting

The doctoral student meets with his or her doctoral committee members during the CEL-790 (Dissertation Proposal Development) course after the student has sufficiently conceptualized his or her dissertation study, but within ample time to integrate any needed adjustments prior to the actual proposal defense. This is an opportunity for committee members to weigh in and provide their feedback on the following: the

research problem, purpose of the study, research questions, theoretical rationale, and methodology. Students are to submit a 1-2 page summary of these areas to their committee members one week prior to the meeting. Usually, the session is of a one-hour duration.

Dissertation Proposal

Students must present completed Chapters I, II and III of the dissertation at the time of the proposal defense: the Research Problem, Review of the Literature, and Methodology. Students should consult the *Doctoral Student Handbook* and their 709 instructor for further details. Prior to the proposal defense, students should:

- Submit the IRB application (where required)
- Set a defense date, time and format of defense after consultation with and approval by the chair (see below)
- Schedule a room with the Doctoral Program Assistant
- Submit copies of the proposal to committee members three weeks before the defense date

APA

The approved style of citations for use at the School of Education is the American Psychological Association format. The *APA Manual* (6th Edition) is available in the USF Bookstore.

Dissertation Committees

Students select the chair they believe will be most beneficial to them in consideration of their particular dissertation topic. The additional two readers are chosen after consultation with the chair. Where appropriate, one reader may be from the USF faculty outside the School of Education. If the chair is not a CEL faculty member, the student must petition for a policy exception to the Doctoral Program Policies Committee. If approved, two of the readers must be from the CEL faculty.

Change of Committee

Should a need to change members occur, the student should consult the dissertation chair or the Associate Dean for the proper procedure.

Institutional Review Board for the Protection of Human Subjects

The Institutional Review Board for the Protection of Human Subjects (IRBPHS) has a website that contains details, requirements and downloadable forms: <http://usfca.edu/soe/students/irbphs/>

Statisticians and Editors

A student may consult a competent statistician as an expert to ascertain the most effective statistical treatment for arriving at answers to research questions. The doctoral student is expected to design the methodology but may discuss it with a statistician. A statistician may also run the data. The student should be able to defend the choice of the statistical method(s) and analysis and be able to explain them at the time of the proposal defense. The student may also consult the statistician about the most appropriate wording when reporting the statistical findings. The School of Education has statistical assistance available. Contact: stathelp@usfca.edu.

A student may employ the services of an editor to proofread and make suggestions about the clarity, choice and use of words, sequence, placement, sentence structure, punctuation, etc., but the writing must be that of the doctoral student.

Scheduling the Dissertation Defense

It is the student's responsibility to coordinate details of a defense (date/time) with the chair and committee members, then reserve the room with the Doctoral Program Assistant. Students and committee members will receive a confirmation email of the day, time, and room. Allow two hours for each defense. Committee members are to receive the proposal three weeks before a proposal defense, and four weeks before a dissertation defense.

Signature Forms

After the proposal defense, the committee members sign the *Results of Dissertation Proposal Review* form (available from the Doctoral Program Assistant). For the final defense, students create a signature form to bring to the defense with the names of committee members typed out and ready for their signatures. See the *Doctoral Student Handbook* for the proper format. The form is given to the chair before the defense begins.

Prayer and Opening Statement

Please consult with the chair for content and format.

Guests

Students must first seek the approval of their chair and committee members before extending any invitations to the defenses. If approved, guests should be introduced to committee members. They do not participate in the defense. Students and guests leave the room before the committee begins its deliberation.

After the Proposal and Final Defense

For both the proposal and dissertation defenses, students receive signatures of the chair once all necessary corrections are made and the final document is submitted. Other members of the committee may sign off at the conclusion of the defense. Consult the *Doctoral Student Handbook* and the *Final Procedures Packet* for submission procedures.

Abstract and Acknowledgements

The abstract and acknowledgements are written after a successful dissertation defense. Consult the *Doctoral Student Handbook* regarding the abstract. Regarding acknowledgments, you may wish to consult other dissertations for samples.

Dissertation Purchases

Copies of dissertations may be purchased from University Microfilms International (UMI) Dissertation Services, 300 North Zeeb Road, Ann Arbor, Michigan 48106. Call the toll-free number: 1-800-521-0600, or order on-line (free of charge) through the USF website (Gleeson Library). It is customary to present a bound copy of the dissertation for inclusion in the Newman Library.

Campus Services

Communications

- **Change of Address/Phone/Email:** Changes to students' address, phone, or email should be done online using their USFconnect account. Please also notify the ICEL office of any changes.
- **Email:** All matriculating USF students have an e-mail account. Non-matriculating students may obtain a temporary account by contacting the Center for Instruction and Technology (CIT). The CIT (located in the SOE basement), as well as the computer lab in the University Center and computer stations in Gleeson library, are equipped for USFconnect and e-mail access.
- **Student Mail Folders:** Each student is given a file folder for departmental and personal communications. File folders are located in a file cabinet in Room 210 of the School of Education, in proximity to the CEL Program Assistant's office area. There is a file in the cabinet for every CEL student. Students are encouraged to leave their communications for fellow students in their file folders. **Do not leave confidential information in these folders.**
- **The ICEL MONITOR:** *The ICEL Monitor* is published via email. To be added to the mailing list or to report news of interest, please send an email to icelmonitor@usfca.edu .

Graduate Student Association

The Graduate Student Association (GSA) consists of graduate students from all departments, either M.A. or Ed.D. students, and serves as a liaison between the students and various parts of the University.

Bookstore

The bookstore is located on the ground floor of University Center. Phone: 422-6493. Visit the USF Bookstore website to find posted hours of operation, required texts for courses or to order online directly through the bookstore: <http://usfca.edu/bookstore/> .

One-Stop Enrollment and Financial Services Office

The One Stop office is located on Lone Mountain in Room 251 and the phone number is 415-422-2020. One Stop houses the former offices of the Registrar, Bursar, and Financial Aid. Please visit the One Stop office's website for office hours and an accurate listing of services that they provide: <http://usfca.edu/onestop>

Computer Centers

Macintosh and PC's are available for use in the Center for Instruction and Technology (CIT) (basement-level of the School of Education). Phone: 415-422-2223. Computers are also available in the University Center (Parina Lab), Cowell 225/226, Gleeson Library, and McLaren 131/133. The main number for Information & Technology Services (ITS) is: 415-422-6668. Please visit the ITS website for an accurate listing of services that they provide: <http://usfca.edu/its/help/students/>

Liturgies on Campus

St. Ignatius Church (on campus) liturgies are celebrated Monday - Saturday at 8:00 a.m., and 12:05 p.m. Liturgies are at 5:00 p.m. on Saturday, and on Sunday at 8:00 a.m., 9:30 a.m., 11:00 a.m., and 5:00 p.m. ICEL students and faculty are welcome.

Health Services

The USF clinic is located at St. Mary's Medical Center, 450 Stanyan Street, Level A. Enter main hospital entrance from either Shrader or Stanyan streets. Take elevator to Level A & follow signs. Phone: 415-750-4980. Fax: 750-8155

Gleeson Library/Geshke Center

A valid USF ID is needed to enter the Gleeson Library. Phone: 415-422-2660. Reference Department is 415-422-2039. Visit the Gleeson Library/Geshke Center website for hours of operation and an overview of the services the Library provides: <http://usfca.edu/library/>.

Post Office

The post office is located in the Hayes-Healy Hall, lower level. (Entrance is via outside of building facing the baseball field.) Services include stamp and money order sales. Hours: Monday-Friday, 10:00 a.m. to 3:00 p.m. Phone: 415-422-6341.

ATM Machine

ATM machines (Bank of America) are located on the ground floor of Phelan Hall, directly to the left as you walk in the doors.

One-Card Office

The One Card Office issues/validates student I.D.'s and sells DonsDollar\$. The office is located in Lone Mountain, room 130. Office Hours are Monday through Friday from 9:00 a.m. to 5:00 p.m. 415-422-7663.

Counseling and Psychological Services

Counseling and Psychological Services assists students in developing greater self-understanding and in resolving problems that may interfere with their ability to function in an optimal manner. All counseling is confidential. After an initial assessment is made, the counselor may recommend session-limited individual, couple, or group counseling. When the concern requires longer-term counseling or a more specialized approach, an appropriate referral will be made. The office is located in the lower level of Gillson Hall. For more information, call (415) 422-6351 or visit: <http://usfca.edu/counseling/>

Public Safety

The Department of Public Safety helps create a safe and secure environment where faculty, staff, students and campus visitors can pursue positive work and educational experiences. The Department works collaboratively with the USF community to solve safety and parking/transportation problems, and increase personal and institutional preparedness for natural and other disasters. Most importantly, Public Safety issues parking permits. It is located in University Center and office hours are Monday through Friday from 9:00 a.m. to 5:00 p.m. **Non-Emergencies 415-422-4222. The 24-Hour Emergency Number is 415-422-2911.**

Parking

To park on campus requires a validated parking permit (a valid permit DOES NOT permit parking everywhere on campus). At the time of purchase, permit holders will be told in what lot(s) they may park. The city of San Francisco requires residential parking permits on residential streets near campus. This limits vehicles without permits to two-hour parking increments during the hours of 8:00 a.m. and 8:00 p.m., Monday through Friday. The residential parking restriction does not include the campus side of adjacent streets. **Please check all posted signs before parking your car!**

Dining Facilities

Meals are available in *Market*, located on the 2nd floor of the University Center as well as Crossroads Café on the 1st floor. Limited dining options are offered in *Club Ed* during the spring and fall semesters only (sorry, no services during SummerWest) in the basement of the School of Education. Check the doors for hours of operation. The Wolf & Kettle Café is on Lone Mountain.

Laundry Facilities

Washers and dryers are located in the basement of each residence hall. Check the residence hall desk for times and locations.

Koret Health and Recreation Center

The Koret Health and Recreation Center is a modern facility containing a fully-equipped weight room, aerobics room, five racquetball courts, a cardiovascular exercise area, and a multi-purpose pavilion that accommodates basketball, volleyball and badminton courts, and the largest indoor swimming pool in Northern California. Adjunct Faculty must pay a fee to use this facility. Matriculating students may use the center with a valid USF I.D. Phone: 415-422-6821.

Appendix A:

Faculty Addresses and Telephone Numbers (✓ Indicates preferred means of contact)

Nancy Barrett
Holy Names High School
4660 Harbord Drive
Oakland, CA 94618
510/450-1110 x 117

✓ nbarrett@hnhsoakland.org

Michael Duffy
USF – Lane Center, KA 227
2130 Fulton Street
San Francisco, CA 94117
415/422-2404

✓ Duffy@usfca.edu

John Martin Fixa, O.P.
1555 34th Avenue
Oakland, California 94601

✓ 510/533-5768

✓ Johnnie@msjdominicans.org

Marcella Fox
505 Maureen Lane
Pleasant Hill, CA 94523
925/682-5962

alnmarcy@aol.com

Brian Haggarty
PO Box 4851
Missoula, MT 59806
406/594-1461

✓ phaggarty@montanacc.org

John James
315 Marion Avenue
Webster groves, MO. 63119
(314) 445-4406 (Cell)

✓ jamesjt@slu.edu

Doreen Ferreira Jones
18319 Pepper Street
Castro Valley, CA 94546
510/581-2295

jonesdf@usfca.edu

Virginia (Gini) Shimabukuro
USF – School of Education
2130 Fulton Street
San Francisco, CA 94117-1071
415/422-6934

✓ shimabukurog@usfca.edu

Edward van Merrienboer, O.P.
Dominican Provincial Office
1909 South Ashland Avenue
Chicago, IL 60608
312/666-3244 x34

✓ broedop@aol.com

Sarah Wannemuehler
211 West Hill Drive
Cary, NC 27519
919/468-6152
919/889-5546

WANNEMUEHL@aol.com

Appendix B: **CEL Doctoral Dissertation Titles**

- Sister Ann Muckerman, SSND** (1981)
A Study Relating Social Dynamic Patterns to Gemeinschaft in Two Parochial Schools in San Francisco
- Rev. Carl Schipper** (1982)
A Study of the Perceptions of Catholic Schools by Priests of the Archdiocese of San Francisco
- Rev. Ted Wojcicki** (1982)
Role Perception and Role Expectations of Pastors in Catholic Parish Elementary Schools as Perceived by Pastors, Principals, and Teachers
- Denis Bartlett** (1984)
The Evolution of the Philosophical and Theological Elements of the Jesuit Ratio Studiorum: A Historical Study, 1954-1959
- Sister Alice (Liam) Buckley, CCVI** (1984)
The Relationship Between Readiness to Change in Elementary Catholic Schools and the Faculty's Perception of the Leader Behavior of the Principal
- Raymond John** (1984)
The Relationship of Diocesan Priests, Elementary School Principals, and School Parents of the Archdiocese of San Francisco Toward Lay Administrators and Lay Teachers in the Catholic Elementary Schools
- Clifford Dougherty** (1985)
Reasons Given By Parents Representing Various Ethnic and National Origin Groups for Enrolling Children in Christian Schools
- Rev. Patrick Lee, S.J.** (1985)
The Birthright of Private Education: Pierce V. Society of Sisters
- Brother Kelvin Canavan, S.M.** (1986)
Perceptions and Expectations of Roles, Services, Structures and Goals of the Sydney Catholic Education Office Held by School Principals and Catholic Educational Office Professional Staff
- Rev. Sean Sheehy** (1986)
A Study of the Perceptions of Pastors, Catholic Elementary School Principals, and Teachers Regarding the Catholic Elementary School Teacher as Minister
- Brother Stan Sobczyk, FSC** (1986)
The Relationship between Teacher-Student Personality Type Alignment and Teacher-Assigned End-of-Semester Grades
- Francisco Grijalva** (1986)
Factors Influencing Computer Use by Music Educators in California Independent Elementary and Secondary Schools

- Brother Kevin Convey, FSC** (1987)
A Comparison of Attitudes of Avowed Religious and Lay Teachers and Parents Toward Avowed Religious and Lay Principals in the Christian Brothers High Schools in the St. Louis District
- Terrence Knight McAteer** (1987)
*The Role of the Catholic Elementary School Principal in Receiving Chapter I Services Since the 1985 Felton Decision*⁶
- Rev. Dane Radecki, O. Praem** (1987)
The Identification and Analysis of Factors Contributing to Lay Teacher Attrition and Retention in Catholic High Schools
- Sister Martha Rolley, SNJM** (1987)
The Identification of Computer Competencies Considered Most Important by Parochial Elementary and Secondary Schools
- Sister Kevina Keating, CCVI** (1988)
A Comparative Analysis of Expectations Held for Beginning Catholic Elementary School Teachers by Catholic College/University Teacher Educators and Catholic Elementary School Principals
- Rev. Michael Kurimay, S.J.** (1988)
The Teacher in the Jesuit Tradition: An Ideal Type Analysis
- Rev. Matthew Costello, OSB** (1988)
The Effects of a Training Program in Active Parenting on the Self Concept of the Child Care Workers and Their Adolescent Charges
- Susan Vignes Hahn** (1989)
An Analysis of the Effect of the WCEA/WASC Accreditation Process on the Elementary Schools of the Archdiocese of San Francisco as Perceived by Administrators, Teachers, and Team Members
- Sister Agnes Vieno, CSC** (1989)
The Institute for Catholic Educational Leadership: An Analysis of Student Expectations and Goal Achievement, 1976-1988
- Sister Mary Katherine Hamilton, IHM** (1989)
A Critical Examination of Education Professionalism: Openings for a Fusion of Horizons Within A Catholic Tradition
- Rev. Michael Ojiego Okpara, Jr.** (1989)
A Study of the Perceptions of the Catholic School by Diocesan Parish Priests and Their Assistant Priests in the Orlu Diocese, Nigeria
- Sister Regina Paulino, SSND** (1990)
A Comparison of the Religious Beliefs and Values of Catholic School Teachers and Educational Leaders in the Catholic Schools in Guam
- Rev. Thomas Bourque, TOR** (1990)
Manager or Visionary: Leadership of Third Order Regular Franciscan-Sponsored Colleges as Perceived by the Presidents and their Administrative Staffs

- Janet Graeber** (1990)
The Effects of Planning and Writing Environment on the Quality of Expository Essays Written by Seventh Grade Catholic School Girls
- Brother Michael Anthony Collins, FSC** (1991)
A Comparison of Racial Attitudes among Students, Teachers, and Parents Toward Blacks in Selected Christian Brothers' Schools
- Larry D. Daugherty** (1991)
A Study of the Relationship Between Enrollment Changes and Select Factors in the Private Secondary Schools in the San Francisco Bay Area
- Sister Mary Walter Duval, SSND** (1991)
The Effects of a Value Centered Curriculum on the Attitudes of Catholic High School Seniors Toward the Role of Women, Economic Poverty, and Racial Injustice
- Ann Meyers Manchester** (1991)
A Comparative Study of Eighth Graders in Catholic Elementary and Middle School in the Areas of Reading Achievement, Self Esteem, and Attitude Toward School
- Martin Mayer** (1991)
Gay, Lesbian, and Heterosexual Teachers: An Investigation of Acceptance of Self, Acceptance of Others, Affectional and Lifestyle Orientation
- Mary Patton** (1991)
*Perceptions of Secondary Social Studies Teachers as Moral Educators Regarding Moral Issues in the Curriculum*¹
- Michael James Steinbrecher** (1991)
A Comparison between Female Graduates of Single-Sex and Coeducational Catholic High Schools and the Attainment of Career Leadership Positions
- Catherine Quinn Thomson** (1991)
Parents' and Principals' Perceptions of Parental Involvement in Catholic Elementary Schools
- Brother James Wisecaver, S.M.** (1991)
The Relationship Between Leadership Style and Religious Atmosphere in Hawaiian Catholic Schools
- Jeannette Holmes Dorsey** (1992)
The Role of the Catholic School Teacher as Model of Gospel Values
- Wade Cogan** (1992)
Enrollment Management Structures and Activities in Assemblies of God Colleges
- Sister Jeanne Bessette, OSF** (1992)
Women Catholic Secondary School Principals as Pastoral Leaders of School Communities: A Participatory Study

- Brother Anthony Lazzetti, FMS** (1992)
The Relationship of Self Esteem and Learning Style Preferences among Selected Students in Catholic High Schools in the Archdiocese of New York
- Sister Mary Mullaly, FSC** (1992)
*A Study of the Viability of the Preventive System of St. John Bosco for the Youth of Today in Salesian Sisters' Schools*¹
- Rev. Thomas Maikowski** (1992)
Criteria Used Altering the Grade Structure of Catholic Secondary Schools to Include Grades Seven and Eight, as Perceived by Diocesan Superintendents and Secondary School Principals
- Margaret Purcell** (1992)
The Relationship between Leadership Style of Principals and the Religious Atmosphere of Parochial Elementary Schools
- Ogden Michael Forbes** (1993)
The Political Evolution of American High-performance Computing and Communications Culture: A Legislative History of Public Law 102-194: (1986-1991)
- Marcella Louise Fox** (1993)
*A Comparison of Female Student Leaders in Single Gender and Coeducational High Schools*¹
- James R. Heyman** (1993)
The Relationships Between Family Structures as Defined by Parental Marital Status, Family Structure Histories, Gender, and Various Academic Outcomes for Seventh Grade Students in Private Schools
- Virginia Hodel Shimabukuro** (1993)
Profile of an Ideal Catholic School Teacher: Content Analysis of Roman and American Documents, 1965-1990
- Larry W. Smith** (1993)
An Assessment of the Effectiveness of Christian School Training as Perceived by Graduates of Selected Schools
- Gregory Alan Brandao** (1994)
Faculty Perceptions Regarding Practice of Brothers of the Sacred Heart New Orleans Province Charism in Community-Owned Secondary Schools
- Diane Ball Cooper** (1994)
An Evaluation of the DeBusk Enrichment Center for Academically Talented Students Summer Enrichment Program as Perceived by Gifted Student Participants and Their Parents
- Young Soon Jun** (1994)
An Analysis of the Effectiveness of the Korean Montessori Teacher Training Program as Perceived by Montessori Teachers and Parents of Montessori-Educated Children

- Rev. Jose Ferreira Ribeiro, S.J.** (1994)
Private Secondary School Principals' Perceptions of Their Role and of the Changes in the Legislation Regarding Private Education in Portugal between 1974-1989
- Mary Fox Webb** (1994)
The Impact of Winning the United States Department of Education Blue Ribbon School Award in Catholic Elementary Schools
- John Collins** (1995)
Parent, Student and Student Personnel Understandings of the Parent-Catholic Secondary School Relationship in Light of Magisterial Principles
- Aine Donovan** (1995)
The Philosophy of Moral Education and the Cultivation of Virtue: An Inquiry into Teachers' Perceptions of Themselves as Moral Educators
- Brother Ed Englund, OSB** (1995)
The Charism of the Rule of Benedict upon the Characteristics of the Secondary Schools of the American Cassinese Congregation
- Mathew M. Heersche** (1995)
International Students' Perception: Transitional Needs and Adjustment Processes at International Catholic Secondary Schools in California
- Matilda Ignacio** (1995)
Lay Women Principals of Catholic Coeducational Secondary Schools
- Rev. Marcellus Auja Kawasonga** (1995)
The Pastoral Role of Catholic School Teachers as Perceived by Priests and Teachers in the Archdiocese of Kisumu, Kenya
- Sister Patricia M. McCormack, IHM** (1995)
Catholic Elementary Schools as Agents of Parent Formation Needs as Perceived by Parents
- Sister Maureen Schaukowitch, OSF** (1995)
Women in Jesuit Higher Education Administration and Their Unique Contributions to the Ignatian World View of Education
- Rev. Steve Shafran, SDB** (1995)
The Educational Method of Saint John Bosco as School Culture in the Salesian High Schools in the United States
- Charles Edward White** (1995)
Expectations of the Beginning Catholic Elementary School Teacher Held by Catholic School Principals and Catholic College/University Teacher Educators
- Sharon Lynn Pace Anderson** (1996)
The Transference of Multicultural Teaching Strategies from Teacher Training Programs to the Classroom

- Rev. Cyril Omo-Osagie Apassa (1996)**
Perceptions of Pastors, Principals, and Teachers of the Catholic Identity of the Roman Catholic High Schools in Owerri Archecclesiastical Province, Nigeria
- Lydia A. Blecksmith (1996)**
Distinguishing Characteristics of Catholic Identity in Catholic Elementary Schools
- Sister Louis Aline Castillon, OSU (1996)**
The Impact of Winning the U.S. Department of Education Recognition Award on Catholic Secondary Schools
- Brother John L. Cummings, FMS (1996)**
The Impact of Non-Catholic Students on the Perceived Catholic Identity of Catholic Secondary Schools
- Eileen Faherty Gorman (1996)**
Fostering the Holistic Development of the Child Through Catholic School Parent Education Programs: Areas of Concern to be Addressed by Parents, Administrators, and Teachers
- Sister Margaret Lynn Lester, BVM (1996)**
The Effects of the Geometer's Sketchpad Software on Achievement of Geometric Knowledge of High School Geometry Students
- Lucille Joan Pendola (1996)**
The Relationship between Scores on the SRI Gallup Catholic School Principal Perceiver Interview and Leadership Effectiveness of Practicing Catholic School Principals
- Sister Christina Heltsley, O.P. (1996)**
A Content Analysis of the Explicit and Implicit Values Implanted in Microcomputer Software in Catholic Elementary Schools
- Margaret Aldridge-Morris (1997)**
Nine-Month Traditional School and a Modified 45-15 Plan Year-Round School in Northern California: A Comparative Study of Academic Achievement and Absenteeism
- Mary Elizabeth Depp-Blackett (1997)**
An Analysis of Legal Issues Affecting the Inclusive Education of Children with Special Needs in Catholic Schools
- Rev. Geoffrey Russell Dillon, S.J. (1997)**
Catholic Secondary-School Principals' Perceptions of Their Involvement in School-Initiated Student Referrals for Psychological Evaluations
- Brother Francis J. David, S.C. (1997)**
An Ideal Type Analysis of the Teacher in the Educational Charism of the Brothers of the Sacred Heart

- Rev. Joseph H. Lackner, S.M.** (1997)
Components of Marianist Educational Culture: A Content Analysis of the Published Works of William Joseph Chaminade and the Phenomenological Interviews of Persons Designated as Best Experienced in Marianist Education
- Gustavo Ramirez Barba, FSC** (1998)
Part-time Faculty and Student Perception of the Usefulness of Student Ratings Feedback for Improving Instruction at LaSalle University, Campus Ciudad Obregon, Mexico
- Mary Dennehy White** (1998)
*A Comparison of Perceptions Regarding Curriculum Among Catholic School Principals and Teachers in California*¹
- Michael Dale McCambridge** (1998)
An Investigation of the Growth of Moral Development in Eighth Grade Students through Process of Drama
- Julia Elizabeth Beck Sieger** (1998)
Role Perceptions and Role Expectations of Pastors in Lutheran Elementary Schools as Perceived by Pastors, Principals and Teachers
- Sr. Marie de Montfort Breaux, SSF** (1999)
The Charism of the Sisters of the Holy Family as Perceived by Pastors, Principals, Faculty, Staff and Parents
- Sister Michele K. Dvorak, PHJC** (1999)
An Analysis of the Principles of Catholic Social Teaching as Applied to Inner City Catholic School Closures
- Elena Carsariego Hines** (1999)
An Investigation of Lay Catholic Elementary School Principals' and Superintendents' Perceptions of Lay Catholic School Principals' Formation for Faith Leadership, Current Needs and Superintendents' Role in this Formation
- William Wasko Macatee** (1999)
The Impact of Sexual Orientation on the Process of Identity Formation in Adolescents as Measured Through Imaginary Audience and Personal Fable Ideation
- Lillian Kathleen Matan** (1999)
A Profile of the Effective High School Administrator of Inner City Schools
- Nancy Oberle Taylor** (1999)
Principals' Perceptions Regarding the Importance of Faith Formation in Catholic Preschools
- Ned Vanders** (1999)
Catholic School Superintendents: An Investigation of Motivation and Job Preparation

- Doreen Ferreira Jones** (2000)
The Perceptions of Teacher Educators Regarding the Preparation of Elementary School Teachers as Facilitators of Student Moral Development
- Rev. James Stuart Prehn, S.J.** (2000)
The Motivational Factors of Recently-hired Lay Teachers in the Secondary Schools of the Detroit Province of the Society of Jesus
- Susan Rothman Seeley** (2000)
Non-Catholic Students in a Catholic Secondary School: A Participatory Case Study
- Sister Jeanne Hagelskamp, S.P.** (2000)
The Effect of Teaching Critical Thinking By Infusion, With Focus on Transfer of Skills, On the Moral Judgement and Critical Thinking of Secondary School Students
- Holly Peterson** (2000)
Relationship of the Educational Pedagogy of Luigi Giussani to the American High School of the 21st Century
- Rev. Michael Caruso, S.J.** (2000)
The Mission and Culture of Jesuit Higher Education: A Comparison of Strategies with the Walt Disney Company
- Sister Bridget Connor, GNSH** (2000)
The Catholic School Secondary Teacher: A Relationship Study of Personality, Gender, And Moral Development
- Rev. Jean Pierre Bongila** (2001)
Funding Strategies for Institutional Advancement of American Private Universities: Application for Congolese/African Universities
- Rev. Augustine Joseph Kuzhikannamthadattil** (2001)
Teacher Efficacy and Preparedness of the Religion Teachers of Catholic High Schools: A Study in the Context of the Archdiocese of Vancouver
- Rev. Ryan Maher, S.J.** (2001)
A Rationale for Interscholastic Athletics in Jesuit High Schools in the United States
- Matthew Hanson Barmore** (2001)
Keeping the Jesuit Tradition Alive: Lay Faculty understanding and Implementation of the Ignatian Identity
- Rev. Stephen Jensen** (2001)
Traits of the Early Church Community Reflected in Catholic Schools: Perceptions of Teachers
- Josie Louise Maxwell** (2001)
Faculty Perceptions of Community in Online and Traditional Courses at Catholic Colleges.

- Brother Michael Alan Tidd, FSC** (2001)
An Examination of the Effectiveness of formation Programs in Fostering the Values of Lasallian School Culture in Lay Educators in Lasallian Secondary Schools.
- Edward E. Tywoniak** (2001)
A Content Analysis of Lasallian pedagogy and Its Ontological Application to the Contemporary Culture of Technology.
- Rev. Timothy Eden, S.M.** (2002)
Seasons of Change: Catholic Higher Education from the End of the Second World War to the Decade Following the Second Vatican Council
- Susan Fulton** (2002)
Role Perceptions of Pastors and Principals in Parish Schools and the Role of the Catholic School in a Parish As Perceived by Pastors and Principals
- Louse Alcott-Lutz** (2002)
The Perception of Administrators and Teachers Regarding Student Achievement and Motivation in Catholic Elementary Schools With Year-Round Education
- Rev. Anthony Mancuso** (2002)
The Motivational Aspects for Teaching in Catholic Elementary Schools in the Diocese of San Jose in California: Who Teaches in These Schools and Why?
- Mary Elizabeth Gorzycki** (2003)
Moral Development: Cold War Pedagogy and Catholic Secondary Education
- Sister Donna Maria Moses, O.P.** (2003)
Four Approaches to the Study of Mary-Model of the Church, 1953-2003
- Rev. Paulson Mundanmani, SDB** (2003)
Manager or Visionary: Leadership of Salesian High and Higher Secondary Schools in India as Perceived by the Principals and Their Faculties
- Ronald Nocetti** (2003)
The Impact of Athletic Participation on the Risk Behaviors of Adolescent Females in Catholic Secondary Schools
- Stephen Phelps** (2003)
A Study of Professional Development in Catholic Secondary Schools Compared to National Staff Development Council Standards
- Dennis Torres Purificacion** (2003)
A Content Analysis of the 104th United States Congress on Education Reform in 1995 and the USCC Document Principles for Educational Reform in the United States
- Cleophas Rutabingwa Kente** (2003)
Leader Behavior of Vice Chancellors as Perceived by the Management Teams in Private Universities in the East African Community

- Melanie Verges** (2003)
Accreditation and School Improvement: Teacher and Administrator Perceptions of the Process for Selected Catholic High Schools in the Southern United States
- Brother Glenn Bolton, FSC** (2004)
Factors Influencing the Persistence Rates of Mexican American College Students
- Edward Fassett, SJ** (2004)
Jesuit Educational Culture in the United States, 1938-1970: A Content Analysis of the Jesuit Educational Quarterly
- Lisa Harris** (2004)
The Motivational factors Encouraging Teachers to Teach in Catholic Elementary Schools in the Archdiocese of San Francisco, California
- Rev. John Brian Huber, CSB** (2004)
The Accessibility of American Catholic Secondary Schools to the Various Socioeconomic Levels of Catholic Families in the 21st Century
- Margaret Maughan-Smith** (2004)
*Perceptions and Assumptions: Gender Equity in Jesuit All-Male Secondary Schools*³
- Dorothy J. McCrea** (2004)
Mercy Charism and Its Relationship to Effective Schooling
- Brother Michael Sanderl, FSC** (2004)
Catholic Identity and Lasallian Culture in Higher Education: The Contributions of Ministry
- Rev. Eric Velandria, S.J.** (2004)
A Survey of Lay Tenured Philippine Jesuit High School Teachers' Understanding and Application of the Characteristics of Jesuit Education
- Brother Raymond Vercruyse, CFC** (2004)
The Congruency of Blessed Edmund Rice's Charism with the Essential Elements of a Christian Brother Education in Christian Brothers' Owned Secondary Schools in the United States
- Michael Duffly** (2005)
Directives in Catholic Social Teaching for the Promotion of Justice Within Educational Activities in Catholic Schools
- Brian Hegarty** (2005)
The Use of Moral Education Strategies in American Catholic Schools, Grades Seven and Eight
- Rev. Thomas Simonds, SJ** (2005)
Serious Violence, Triggers for More Serious Violence, and Violence Prevention in Secondary Schools of the Society of Jesus in the United States

- Bruce Colville** (2006)
The Collective Bargaining Agreement between the Secondary Lay Teachers Union and the Archdiocese of San Francisco, 1970-1973
- Rita Cutarelli** (2006)
The Role of the Campus Minister in the Organizational Structure of U.S. Catholic Secondary Schools: Power and Influence for Mission
- Lorraine DiCamillo** (2006)
An Exploration of Classroom Thoughtfulness in High School U.S. History Courses
- Sr. Kathryn Klackner, OSF** (2006)
The Integration of Catholic School Principles into the Curriculum of Elementary Catholic Schools in Wisconsin
- Rev. Anthony Pabayo, SJ** (2006)
The Impact of Technology Use on the Perceptions of Teachers and Student Performance in Christian Life Education in Philippine Jesuit Grade Schools
- Rev. Edward Inyanwachi** (2007)
A Content Analysis of Church Documents Relative to the Role of Catholic Schools in Nigeria in the Process of Inculturation
- Hillary McKinney** (2007)
The Impact of Participation in Collegiate Athletics on Women Athletes' Academic Experience at Select Jesuit Universities
- Godbertha Kagemulo Muganda** (2007)
The Perceptions of volunteers Regarding their Motives, Rewards, and Challenges at St. Anthony's Foundation
- Kevin Quattrin** (2007)
Fighting the Freeloader Effect: Cooperative Learning, Attitude, and Achievement in a Jesuit Secondary math Classroom
- Rev. Jean de Dieu Randrianaivo, SJ** (2007)
The Achievement of Jesuit Educational Goals by Two Jesuit Secondary Schools in Madagascar: Senior Class Perspectives
- Julie Rhynes Alexander** (2008)
Student perspectives on Cooperative learning Skills Taught in Fifth Grade Classrooms and the Impact on Bullying Behaviors
- William Hambleton** (2008)
A Comparison of the Facilitation of Catholic Identity to Male Students at Coeducational Catholic High Schools and Male Single Gender Catholic High Schools

- Anna McDonald** (2008)
An Exploration of Special Education Practices in Catholic Elementary Schools at the Primary Level (K-2)
- Bonnie J. Davis** (2009)
A Qualitative Study of How Writing is Used in Catholic Secondary Schools to Foster Students' Metacognitive Skill Development
- Sandra Jewett** (2009)
A Qualitative Exploration of Professional Development for Beginning Principals in K-8 Catholic Education in the San Francisco Bay Area
- Sr. Elizabeth O'Donnell, OP** (2009)
An Exploration of Adolescent Spirituality in a Single-Gender Urban Catholic High School: A Phenomenological Inquiry
- Ruben Arceo** (2010)
A Study of Perceived Leadership Styles of Seven Jesuit University Presidents in México
- James Bryson Everitt** (2010)
The Experience of Catholic Gay and Lesbian Catholic Secondary School Educators: A Participatory Study
- John Dudley Savard, S.J.** (2010)
The Impact of Immersion Programs upon Undergraduate Students of Jesuit Colleges and Universities
- Philip Barry Thornton** (2010)
Values Sought by Parents Sending Their Children to Selected Catholic High Schools in the San Francisco Bay Area
- Peter Imperial** (2011)
Mainstream Grading Purposes and Practices in Catholic Secondary Schools
- Doug Evans** (2011)
A Quantitative Study of the Effects of Faith Formation Opportunities on Lay Educators in Catholic Secondary Schools

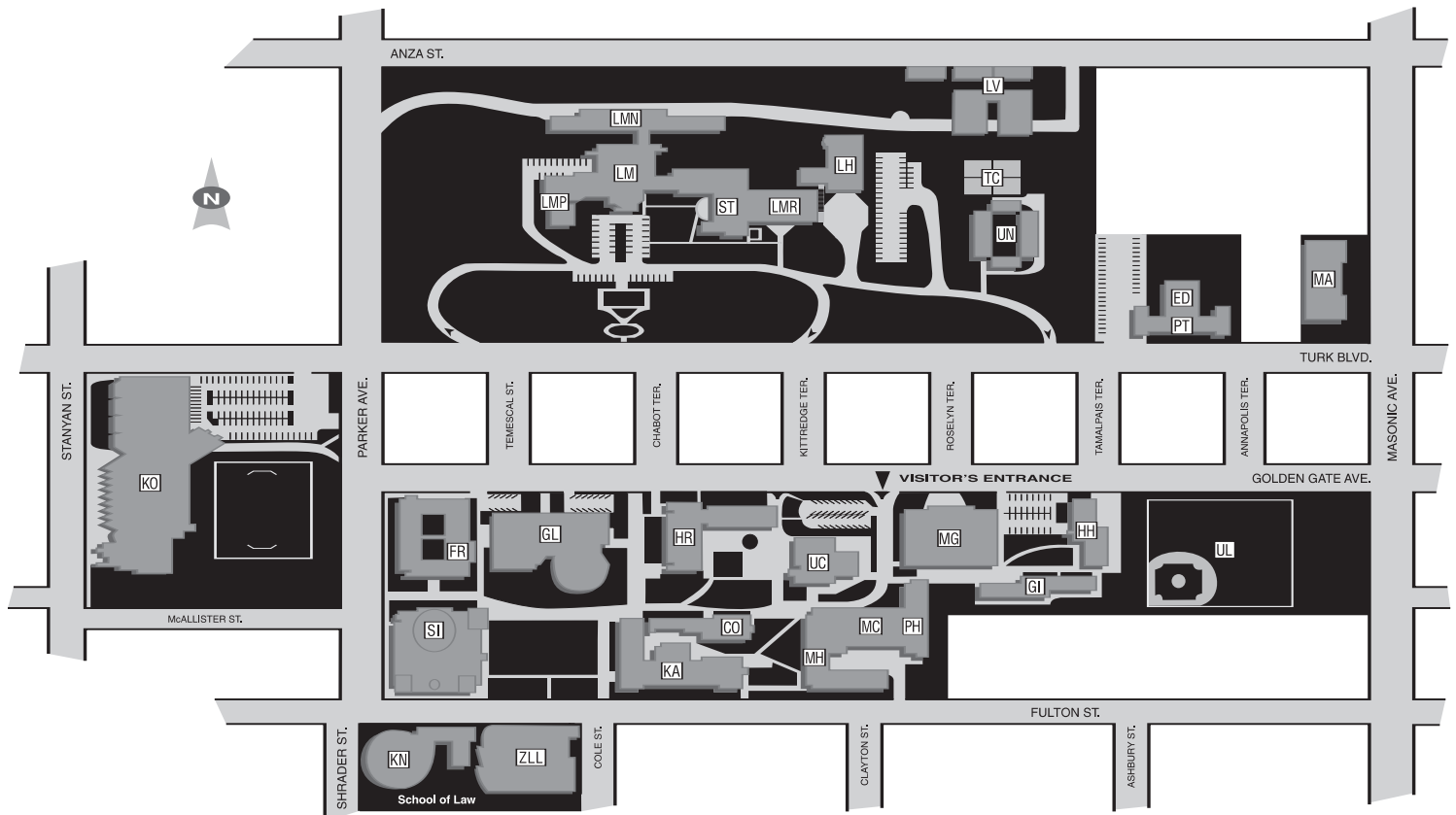

Main Campus

- CO Cowell Hall
- FR Fromm Hall
- GI Gillson Hall
- GL Gleeson Library
- HH Hayes-Healy Hall
- HR Harney Science Center
- KA Kalmanovitz Hall
- MC McLaren Conference Center
- MG Memorial Gymnasium
- MH Malloy Hall
- PH Phelan Hall
- SI Saint Ignatius Church
- UL Ulrich Field & Benedetti Diamond
- UC University Center

Lone Mountain Campus

- LH Loyola House
- LM Main Bldg/Classrooms/Study Hall
- LMN Lone Mountain North
- LMP Pacific Wing
- LMR Rossi Wing/Administration
- LV Loyola Village
- ST Studio Theater
- TC Tennis Courts
- UN Underhill Building
- ROTC/Upward Bound

School of Law

- KN Kendrick Hall
- ZLL Dorraine Zief Law Library

Koret Health & Recreation Center

- KO Koret Center

School of Education

- ED School of Education
- PT USF Presentation Theater

281 Masonic

- MA 281 Masonic

Office Locations

Academic and Enrollment Services

Lone Mountain Main

Academic Support Services

Gleeson Lower Level, 20

Admission Office

Lone Mountain Main

Alumni Office

Lone Mountain Rossi Wing, 112

Arts and Sciences, College of

Harney, 240

Athletics

Memorial Gym, Lower Level

Bookstore

University Center, Lower Level

Business and Professional Studies, School of

Malloy Hall, 244

Career Services Center

University Center, 5th Floor

Counseling Center

Gillson, Ground Floor

Education, School of

Turk at Tamalpais, 107

Financial Aid

Lone Mountain Main

Intercultural Center

University Center, 4th Floor

Information Technology Services

Lone Mountain North, 2nd Floor

International Student and Scholar Services

University Center, 5th Floor

Koret Health and Recreation Center

Corner of Parker and Stanyan

Law Library, Dorraine Zief

Corner of Fulton and Cole

Law, School of

Corner of Fulton and Shrader

Loyola House/Jesuit Community

Lone Mountain, 2600 Turk Street

One Card

Lone Mountain Main, 130

One Stop Enrollment and Financial Services

Lone Mountain Main, 250

Nursing, School of

Cowell, 102

Public Safety

University Center, 310

Registrar's Office

Lone Mountain Main, 250

Residence Life

University Center, 5th Floor

Student Disability Services

Gleeson Lower Level, 20